

Zhejiang Huayi Precision Machinery Co.,Ltd
浙江华益精密机械有限公司



浙江省诸暨市店口镇解放路689号
No 689 Jiefang Road Diankou Industry Zone
Zhujia ,Zhejiang ,China

+86 - 575 - 8900 - 7784

ENTERPRISE INTRODUCTION

企业介绍

浙江华益精密机械有限公司成立于 1999 年,是浙江迪艾智控科技股份有限公司全资子公司,公司专注于精密金属、工程塑料零部件、集成部件的研发、制造与销售,业务涵盖家电厨卫和工业相关的装备、设备等行业配套。

公司积累了二十多年与国际一流企业合作的管理经验,推行品质零缺陷理念,相继获取了 ISO9001、ISO14001、ISO45001 及 IATF16949 的体系认证。公司按 IATF16949 的要求,严格推行五大工具的应用: APQP、PPAP、FMEA、MSA、SPC,通过过程能力指数 Cpk 的管理,确保制造过程可控,保证工序的一次合格率。公司与 A.O.SMITH、TOTO、Panasonic、ESAB、KARCHER、Vaillant、NAVIEN、美的、海尔等国内外一流企业建立了长期稳固的合作伙伴关系。公司拥有领先的精密锻造及制造技术,拥有先进的生产设备,致力于为客户提供一流的产品与服务。

Since its inception in 1999, Zhejiang Huayi Precision Machinery Co.,Ltd has established itself as a premier manufacturer of precision metal components, engineering plastic parts, and integrated modules. As a wholly-owned subsidiary of Zhejiang DA Control Technology Co.,Ltd, we deliver critical engineering solutions across diverse key industries, ranging from the Home Appliance and Kitchen & Bath sectors to specialized equipment in the industrial field.

Building on over two decades of operational excellence working with top-tier international enterprises, Huayi champions a definitive "Zero Defect" quality philosophy. We uphold a rigorous, globally validated management standard, fully certified to ISO 9001, ISO 14001, ISO 45001, and IATF 16949. We strictly implement the automotive industry' s Five Core Tools: APQP, PPAP, FMEA, MSA, and SPC to ensure the consistency of the process. By leveraging these tools alongside rigorous Cpk process capability management, we maintain overall control over the manufacturing process, guaranteeing an exceptional First Pass Yield (FPY) across all delivered components.

Driven by these exacting standards, we have solidified our standing as a trusted strategic partner to world-class enterprises. We are proud to serve as a long-term strategic partner to global industry leaders including A.O. Smith, Panasonic, TOTO, ESAB, Kärcher, Vaillant, and Navien, as well as domestic giants such as Midea and Haier. Backed by leading-edge precision forging technologies and the state of the art production facilities, we remain dedicated to providing first - class products and services that drive our clients' success.



1999 ▶

OUR CULTURE

企业文化



企业使命 Corporate Mission

为客户创造价值，
为企业创造效益，
为员工创造平台，
为社会创造财富。

To create value for customers
To drive sustainable growth for the enterprise
To build development platforms for employees
To contribute to the advancement of society.



企业愿景 Corporate Vision

成为具有国际竞争力的
精密零部件企业

To become a globally
competitive leader
in the precision
component industry.



核心价值观 Core Values

诚信、尊重
专业、专注

Integrity, Respect,
Professionalism,
and concentration.



企业精神 Enterprise Spirit

坚韧、创新
善为、求精

Resilience, Innovation,
Excellence, and
Perfectionism.

CORE COMPETITIVENESS

核心竞争力

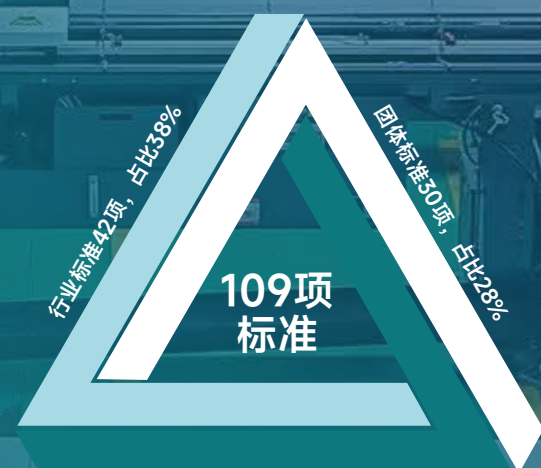
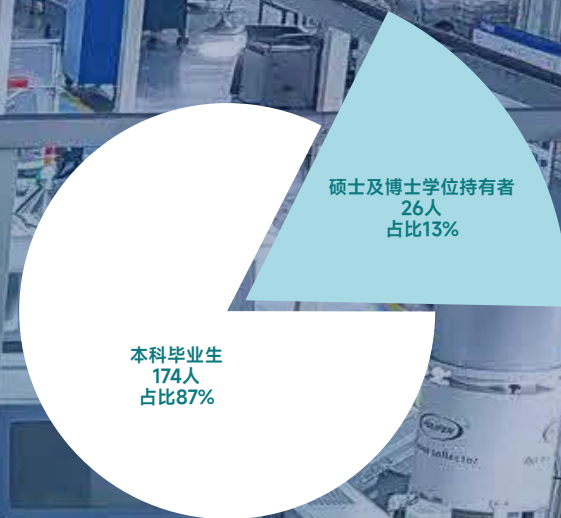
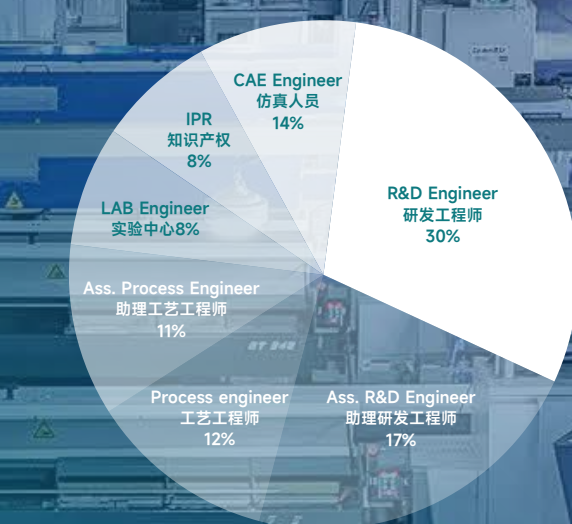

国家标准37项，占比34%

- 37 National Standards
- 42 Industry Standards
- 30 Group Standards

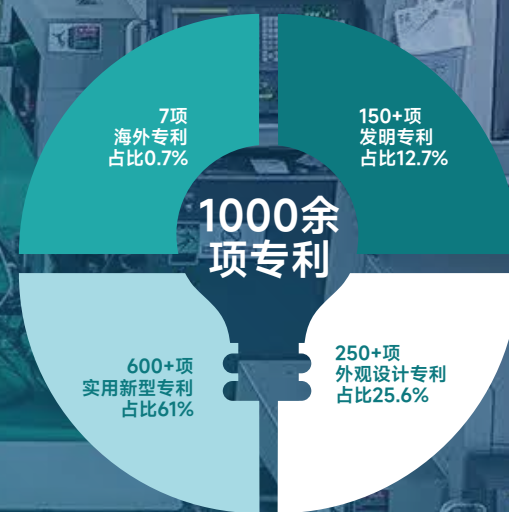

- 1000+ patents
- 7 Overseas Patents
- 150+ Invention Patents
- 600+ Utility Model Patents
- 250+ Design Patents

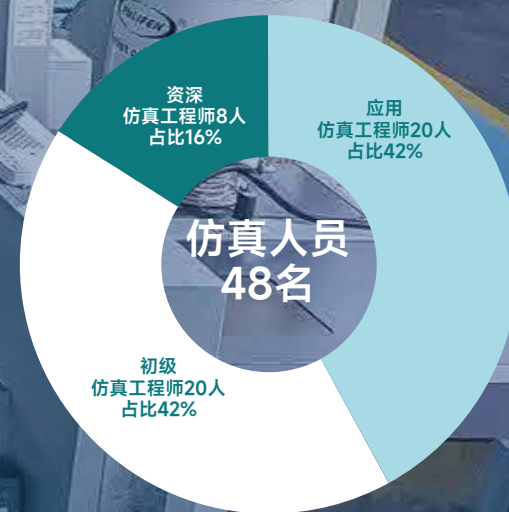

- 8 Senior CAE Engineers
- 20 CAE Application Engineers
- 20 Junior CAE Engineers

OUR PARTNER

合作伙伴



PRODUCTION LINE INTRODUCTION

产品线介绍

公司拥有自主知识产权研发的DPS数字化运营管理系统，全面推行精益生产，快速响应客户需求，从下单到生产完成全流程进入DPS数字化系统，每批订单实现动态实时跟踪管理，满足客户订单交期要求。

HUAYI has developed a proprietary DPS digital operations management system to fully implement lean production and rapidly respond to customer needs. The entire process, from order placement to production completion, is integrated into the DPS system, allowing for dynamic, real-time tracking of every order batch to ensure timely delivery.



机械臂 Robotic Arm



总装车间 Assembly Workshop



锻压车间 Forging Workshop



精加工车间 Finishing Workshop

APPLICATION SIMULATION SOFTWARE

应用仿真软件



结构强度 Structural Strength



优化设计 Optimized Design



流体换热 Fluid Heat Transfer



系统分析 System Analysis



电磁 Electromagnetic



工艺仿真 Process simulation

FORWARD SYNCHRONIZATION R&D CASE

正向同步研发案例

CUSTOMER PAIN POINTS: INSTALLATION AND SEALING PERFORMANCE

Before the structural optimization of the gas filter, its volume was relatively large, the connection threads were fixed, and the exposed sealing parts were prone to failure when connected externally.

The gas filter was developed in parallel with a certain customer through forward research and development, which solved the customer's pain points and formed innovative points. Patent protection was applied for.

After the product structure was redesigned, its volume was reduced, and the connecting thread was changed to a union type, making installation more convenient. The sealing parts are not exposed, which enhances reliability and has been patented, receiving high praise from customers.

客户痛点：安装与密封性

燃气过滤器，结构优化前体积较大，连接螺纹是固定式，密封件暴露与外接容易失效。

燃气过滤器与某客户同步研发，正向研发，解决了客户的痛点，形成的创新点，申请了专利保护。

产品结构重新设计后，体积减小，连接螺纹改活接式，安装更方便。密封件不外露，提高了可靠性，并申请专利，受到客户好评。

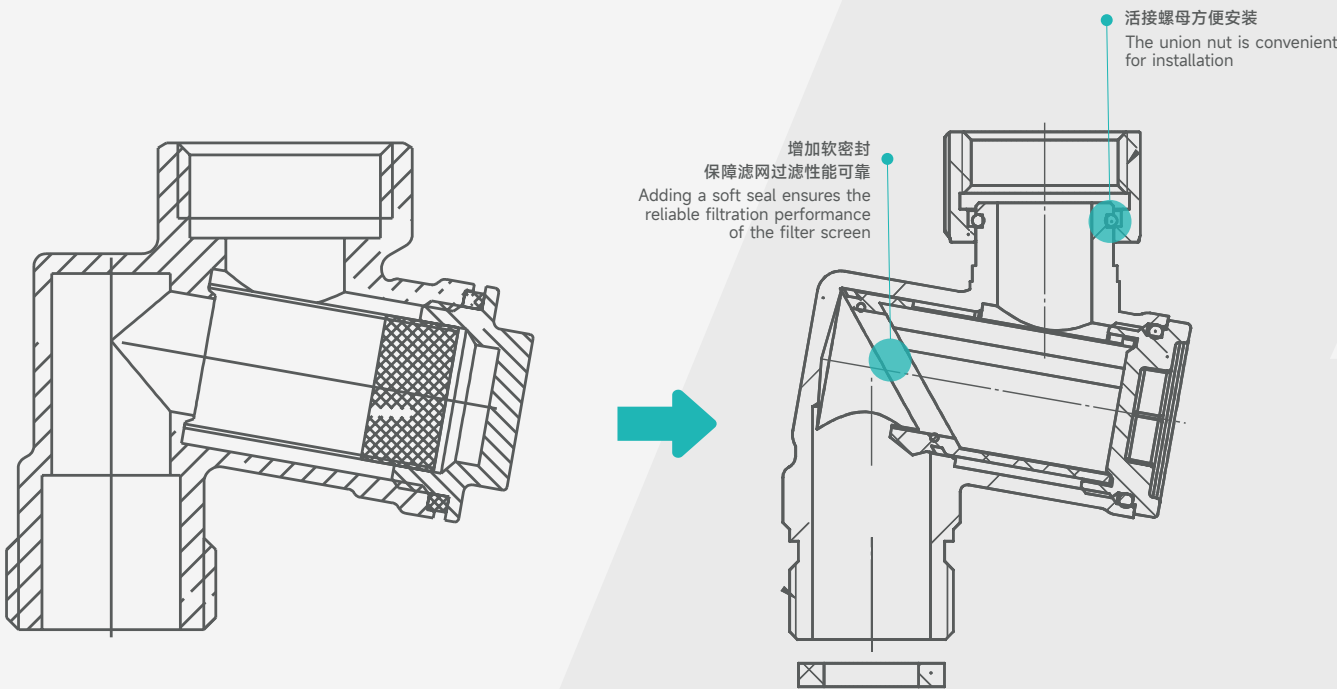

FORWARD SYNCHRONIZATION R&D CASE

正向同步研发案例

Three valves are combined into one valve, addressing the pain points of customers, achieving cost reduction, convenient installation, and solving the sealing problem at the same time.

三阀合成一个阀，针对客户的痛点，实现成本降低、安装方便，同时解决了密封问题

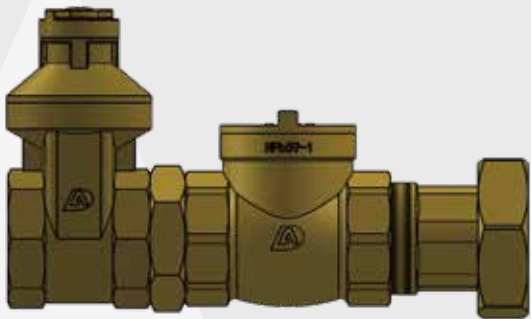

Stop Valve
+ Check Valve
+ Water Meter Adapter
截止阀 + 止回阀 + 水表转接头

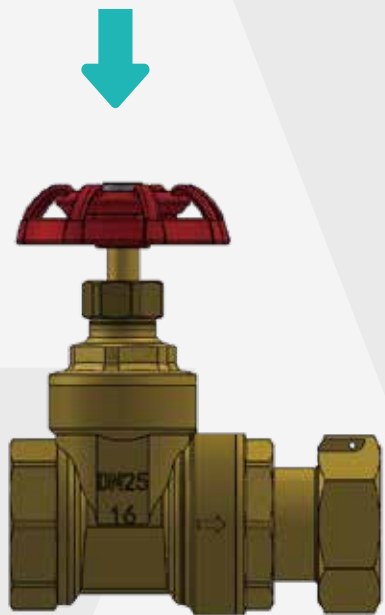

Design as a Stop Valve
with Check Valve Function
设计成为带止回功能的截止阀

STRUCTURAL STRENGTH SIMULATION CASE

结构强度仿真案例

TARGET

Increase the rotational load-bearing capacity of the filling valve.

METHODS

For the filling valve, configure the mating/locating position as a straight slot plus a right-angle shoulder.

RESULTS AFTER OPTIMIZATION

Simulation results of the improved design show a 134% increase in load capacity over the original.

- 1. 分析目的：增加补水阀旋转受力强度。
- 2. 改善方案：补水阀配合位置设计为直槽 + 直角凸台
- 3. 改善后的仿真分析得出：相比原方案承载性能提升 134%。



补水阀被运输顶坏
Filling Valve was damaged during transportation

CONCLUSION

Experimental results show that the verification result of the improved scheme is 100% higher than that before the improvement, which is in good agreement with the simulation result of 134%. Simulation data is valid.

结论

经过试验验证,改善方案的验证结果比改善前提升了 100%，与仿真结果的 134% 较符合。仿真数据有效。

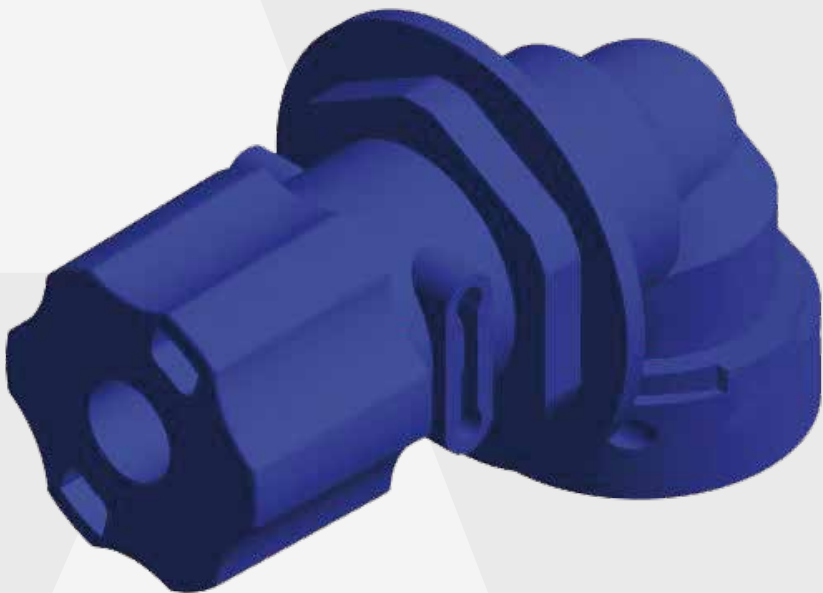
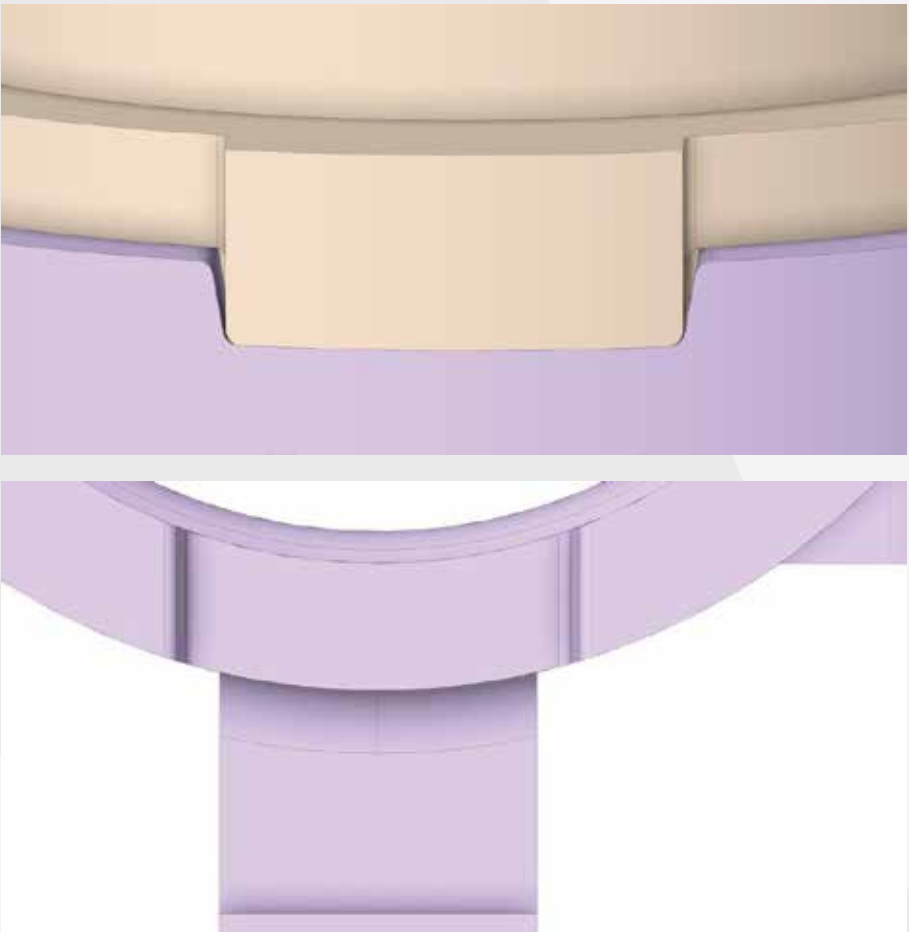

Maximum Principal Stress
Type: Maximum Principal Stress
Unit: MPa
time: 0.2s

最大主应力
类型：最大主应力
单位：MPa
时间：0.2s

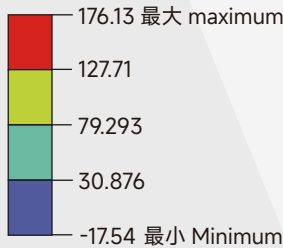

LABORATORY INTRODUCTION

实验室介绍

公司在行业内率先实现产品质量追溯管理，产品生命周期可追溯到产品实现的整个过程，并拥有通过CNAS认证的国家级实验中心，涵盖近40项检测项目，用数据展现产品可信赖的性能。

The company was the first in the industry to implement product quality traceability management, product lifecycle is traceable throughout the entire product realization process.

It also has a national-level experimental center certified by CNAS, covering nearly 40 testing items, and uses data to demonstrate the reliable performance of the products.



CNAS实验室 CNAS Laboratory



CNAS实验室 CNAS Laboratory



三坐标 CMM



图像尺寸测量仪
Image Size Measuring Instrument



TP阀测试台
TP Valve Testing Bench



X-ray膜厚分析仪
X-Ray Film Thickness Analyzer



直读光谱仪
Optical Emission Spectrometer



粗糙度轮廓仪
Hommel Roughness
Tester



圆柱度仪
Cylindricity Measuring
Instrument



影像测量仪
Image Measuring
Instrument

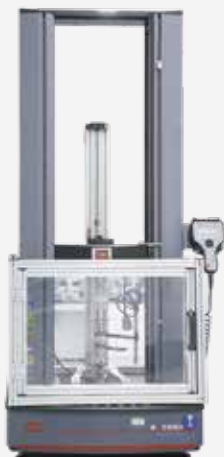

万能试验机
Universal Testing
Bench



水路实验室
Hydraulic Block Laboratory

PRODUCT CATEGORY

产品大类

1. 燃气壁挂炉水路模块 Wall-Hung Boilers (Hydraulic Block)
燃气壁挂炉安全阀 Wall-Hung Boilers (Safety Valve)
2. 燃气热水器进出水阀 Gas Water heater (Inlet & Outlet Valve)
3. 容积式热水器TP阀 Tank Water Heater (T&P Relief Valve)
4. 智能卫浴配件 Sanitary Accessories
5. 焊接焊割配件 Welding & Cutting Accessories
6. 高压清洗机配件 High Pressure Washer Accessories
7. 传感器配件 Sensor Accessories
8. 管路件 Pipe Fittings
9. 其他配件 Other Accessories



1. WALL- HUNG BOILERS (HYDRAULIC BLOCK)

燃气壁挂炉水路模块

PRODUCT INTRODUCTION

We provide high-performance, highly reliable hydraulic core components and solutions for renowned wall - hung boiler and heating system brands. Our product ranges from integrated hydraulic modules, pump and valve connections, to sensor interfaces and customized piping structures, meeting the rigorous sealing, pressure resistance, and corrosion resistance requirements for applications spanning from residential heating to commercial thermal systems.

Upholding stringent standards in material selection and craftsmanship, we utilize 304 Stainless Steel, brass alloys, and high - performance polymers to ensure superior resistance to water corrosion and high temperatures. By adopting core processes — including precision forging, CNC machining, injection molding, and high - precision leak detection — we guarantee dimensional stability, optimized flow dynamics, and system sealing integrity, thereby facilitating efficient heat exchange and long - term operational stability.

By integrating material science, fluid engineering, and precision manufacturing, we deliver safe, durable, and system ready hydraulic solutions and help our clients improve sustainable and energy-efficient heating technologies.

产品介绍

专注于为壁挂炉及供热系统制造商提供高性能、高可靠性的水路核心部件以及解决方案。产品线全面覆盖集成水路模块、泵阀连接件、传感器接口及定制化管路结构件，满足从家用采暖到商业供热系统的严苛密封、耐压与耐腐蚀需求。

在材质与工艺上，我们坚持高标准，水路关键件广泛采用 304 不锈钢、铜合金、高分子材料确保卓越的耐水蚀、耐高温及长期抗渗漏性能。通过精密锻造、数控 CNC 加工、高分子材料注塑、高精度密封检测及表面处理等核心工艺，保障零件的尺寸稳定性、流道通畅性与系统密封性，助力整机实现高效热交换与长久稳定运行。

我们致力于通过材料科学、流体工程与精密制造的融合，为全球壁挂炉与热能系统制造商提供安全、耐用、集成化的水路部件解决方案，共同推动绿色节能供热技术的发展。



**Drafter of the Standard for Hydronic Components
Used in Gas-Fired Heating and Hot
WaterBoilers & Water Heaters
燃气采暖热水炉及热水器
用水路组件标准起草者**

1.1 PLASTIC
HYDRAULIC BLOCK

塑料板换水路

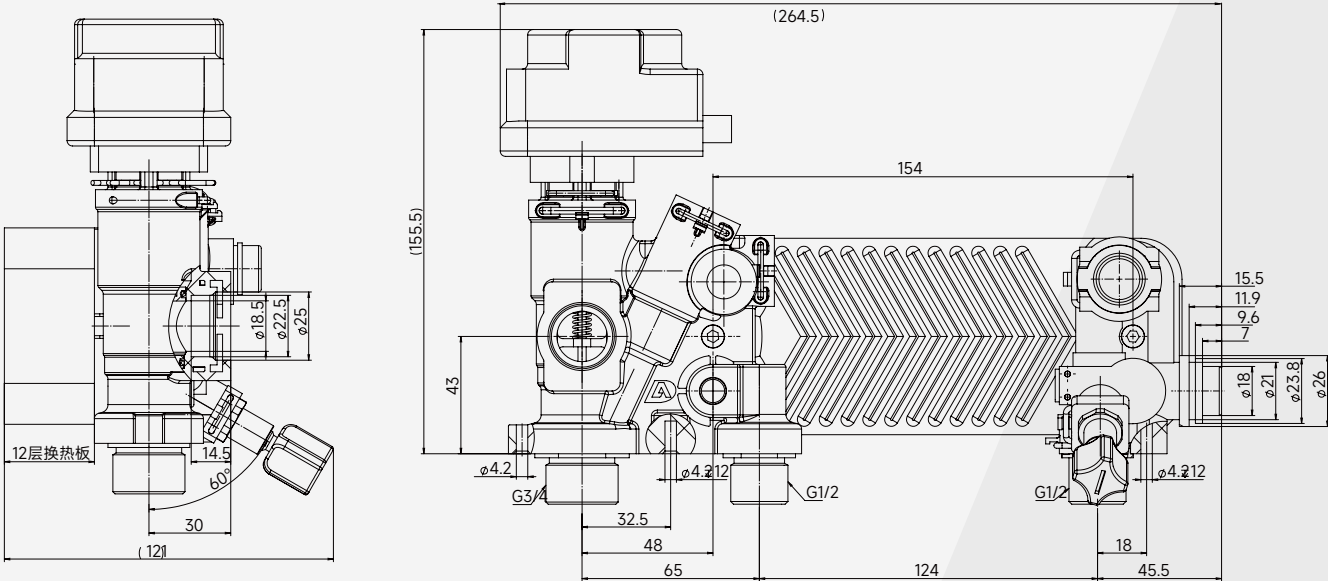

使用环境温度	-20℃ ~ 90℃（无结冰状态）
使用湿度范围	35% ~ 90%RH（无结霜状态）
外泄露	经0.6MPa气压检测25S，无渗漏
三通内泄露	经0.6MPa气压检测25S，无渗漏
流量传感器工作频率	F=（8.1Q-3）±10%
补水流量	≥6L/min
电机工作电	220V；50Hz
旁通可选参数	5M：0.03Mpa<50L/h；0.045Mpa≥250L/h 6M：0.04Mpa50L/h0.055Mpa≥250L/h 7M：0.05Mpa50L/h0.065Mpa≥250L/h

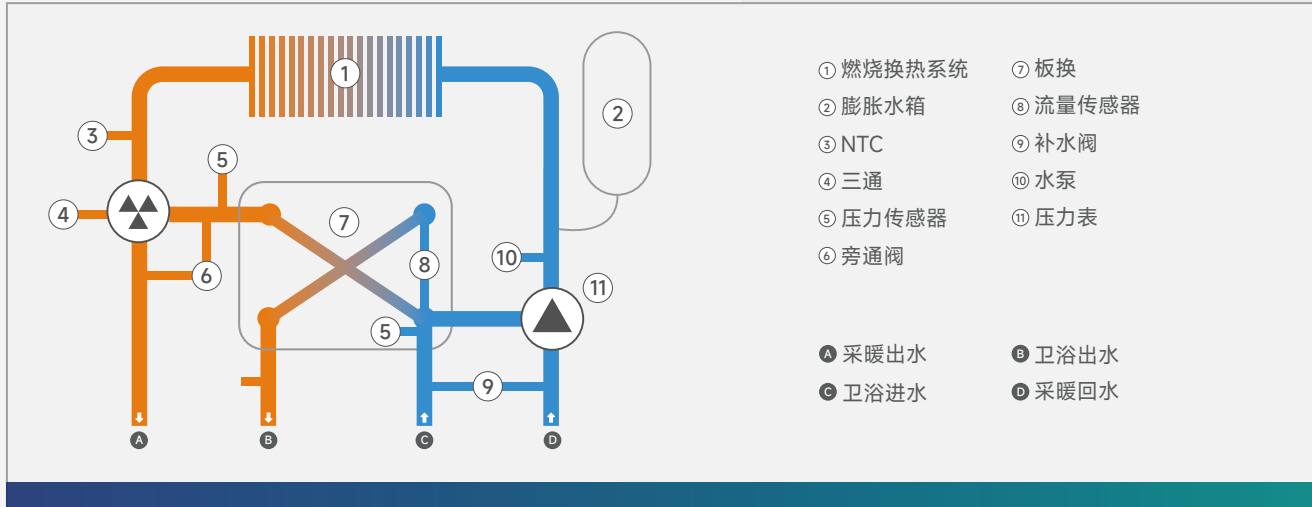

1.1 PLASTIC
HYDRAULIC BLOCK

塑料板换水路

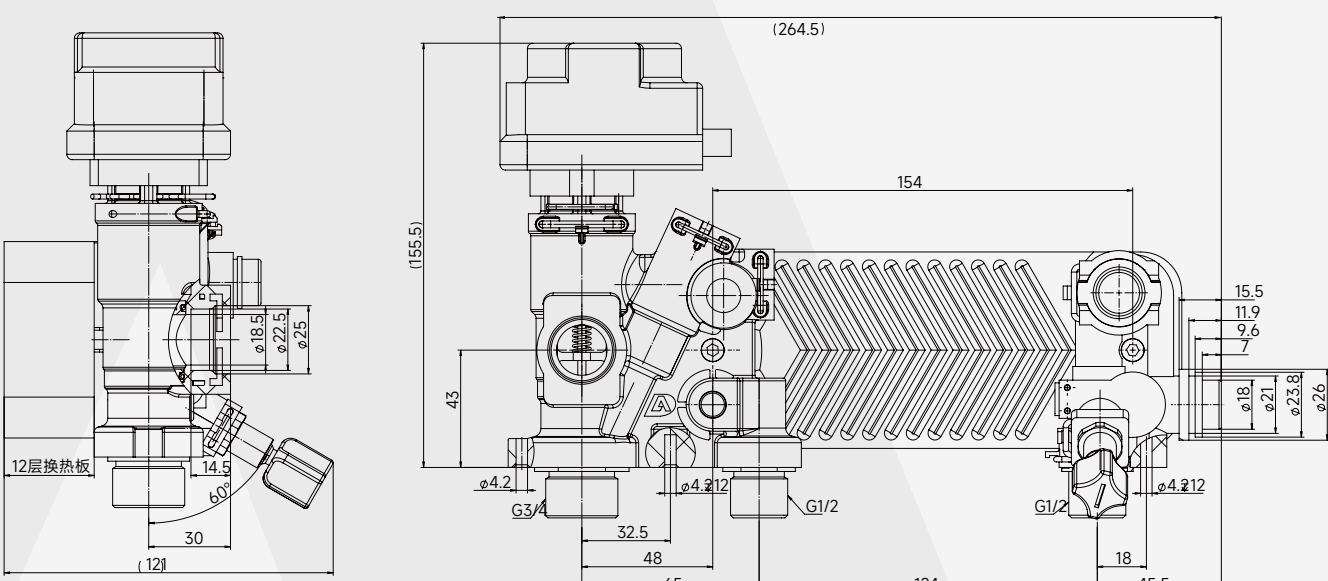

Operating Ambient Temperature	-20℃ ~ 90℃（Ice-free）
Operating Humidity Range	35% ~ 90%RH（Frost-free）
External Leakage	No leakage was found after 25S of 0.6MPa with air pressure detection
Internal Leakage (Three-way valve)	No leakage was found after 25S of 0.6MPa with air pressure detection
Frequency of Flow Sensor	F =（8.1Q-3）±10%
Replenishing water flow	≥6L/min
Operating Voltage	220V；50Hz
Bypass Parameters	5M：0.03Mpa<50L/h；0.045Mpa≥250L/h 6M：0.04Mpa50L/h0.055Mpa≥250L/h 7M：0.05Mpa50L/h0.065Mpa≥250L/h

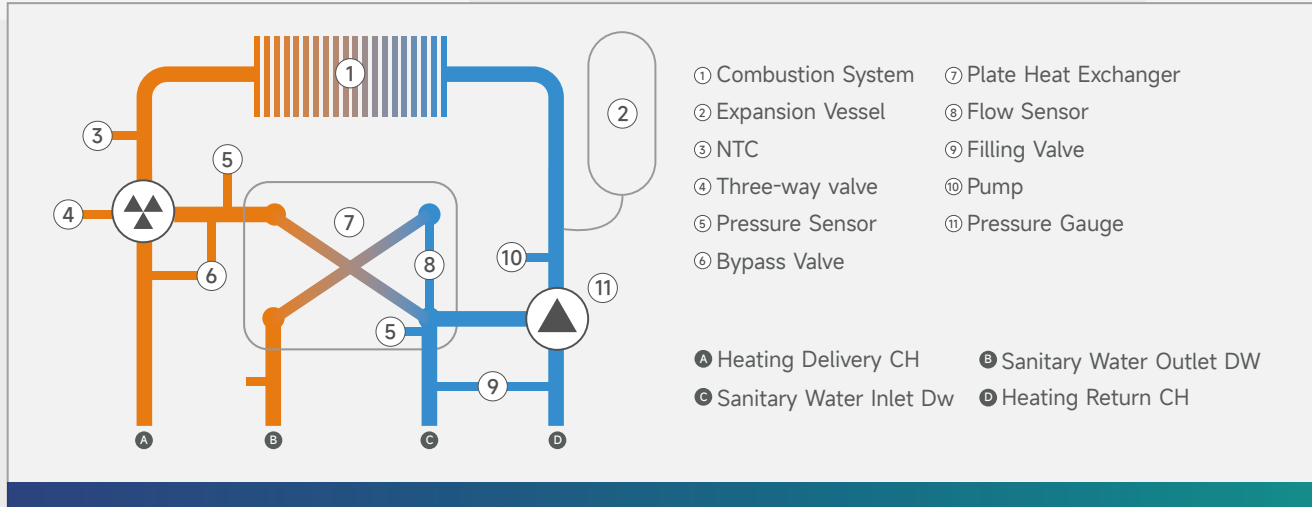

1.2 PLASTIC
HYDRAULIC BLOCK

塑料板换水路

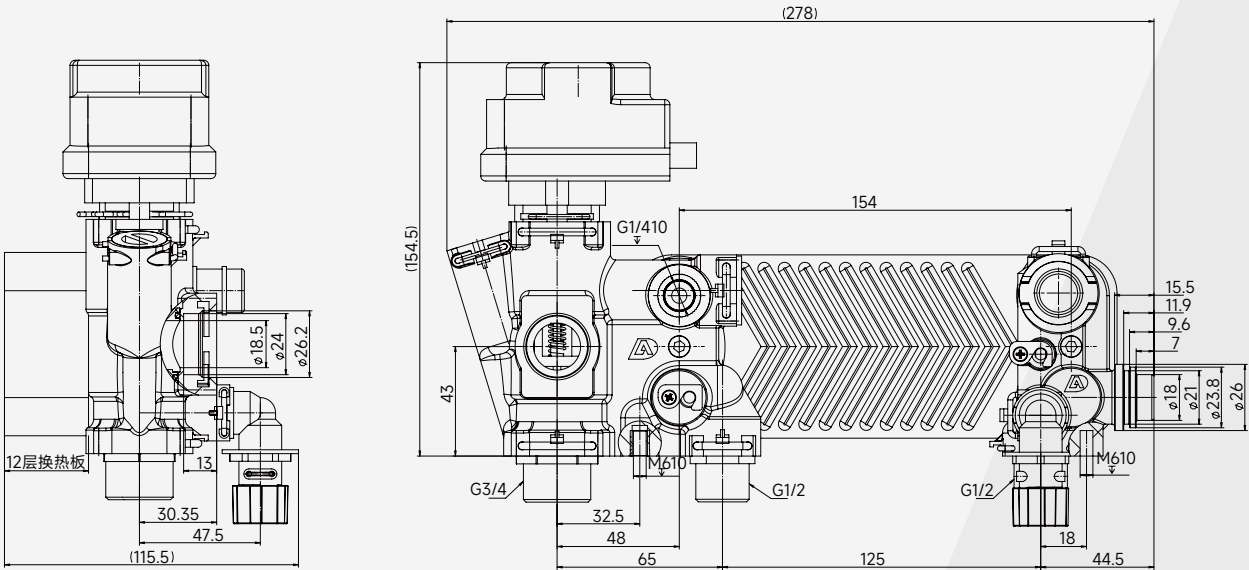

使用环境温度	-20℃ ~ 90℃（无结冰状态）
使用湿度范围	35% ~ 90%RH（无结霜状态）
外泄露	经0.6MPa气压检测25S，无渗漏
三通内泄露	经0.6MPa气压检测25S，无渗漏
流量传感器工作频率	F=（8.1Q-3）±10%
补水流量	≥6L/min
电机工作电	220V；50Hz
旁通可选参数	5M：0.03Mpa < 50L/h；0.045Mpa ≥ 250L/h 6M：0.04Mpa 50L/h 0.055Mpa ≥ 250L/h 7M：0.05Mpa 50L/h 0.065Mpa ≥ 250L/h

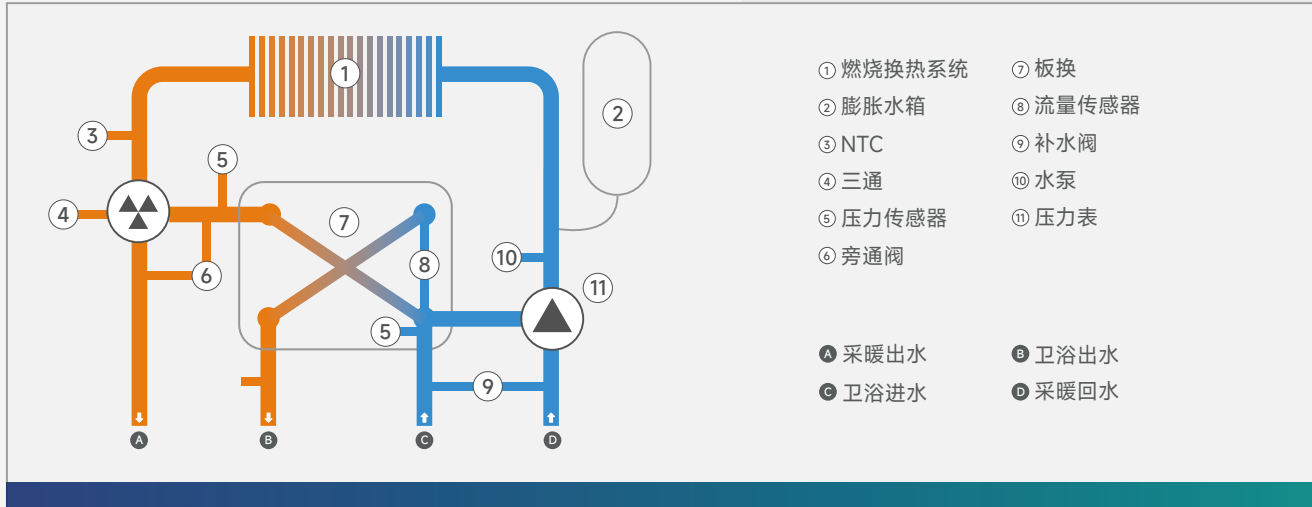

1.2 PLASTIC
HYDRAULIC BLOCK

塑料板换水路

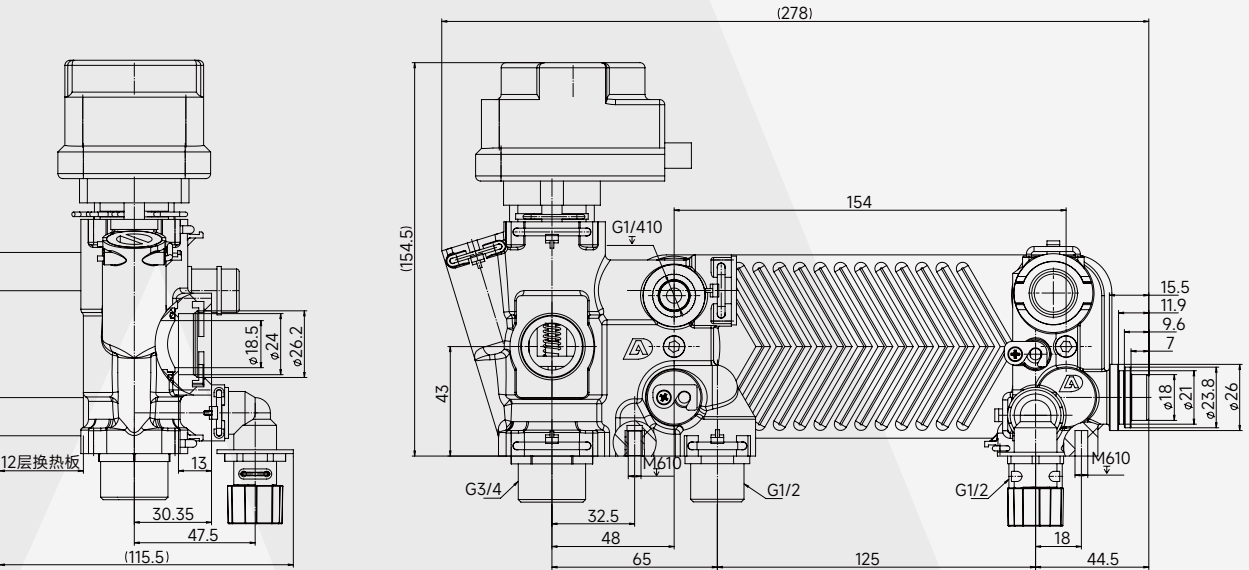

Operating Ambient Temperature	-20℃ ~ 90℃（Ice-free）
Operating Humidity Range	35% ~ 90%RH（Frost-free）
External Leakage	No leakage was found after 25S of 0.6MPa with air pressure detection
Internal Leakage (Three-way valve)	No leakage was found after 25S of 0.6MPa with air pressure detection
Frequency of Flow Sensor	F =（8.1Q-3）±10%
Replenishing water flow	≥6L/min
Operating Voltage	220V；50Hz
Bypass Parameters	5M：0.03Mpa < 50L/h；0.045Mpa ≥ 250L/h 6M：0.04Mpa 50L/h 0.055Mpa ≥ 250L/h 7M：0.05Mpa 50L/h 0.065Mpa ≥ 250L/h

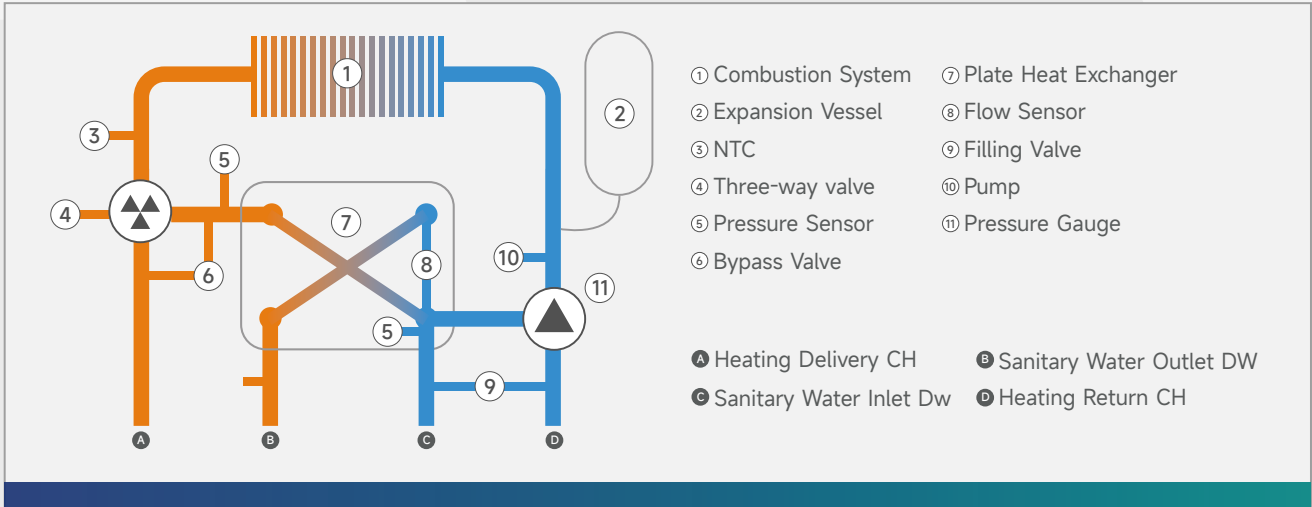

1.3 BRASS
HYDRAULIC BLOCK

铜板换水路

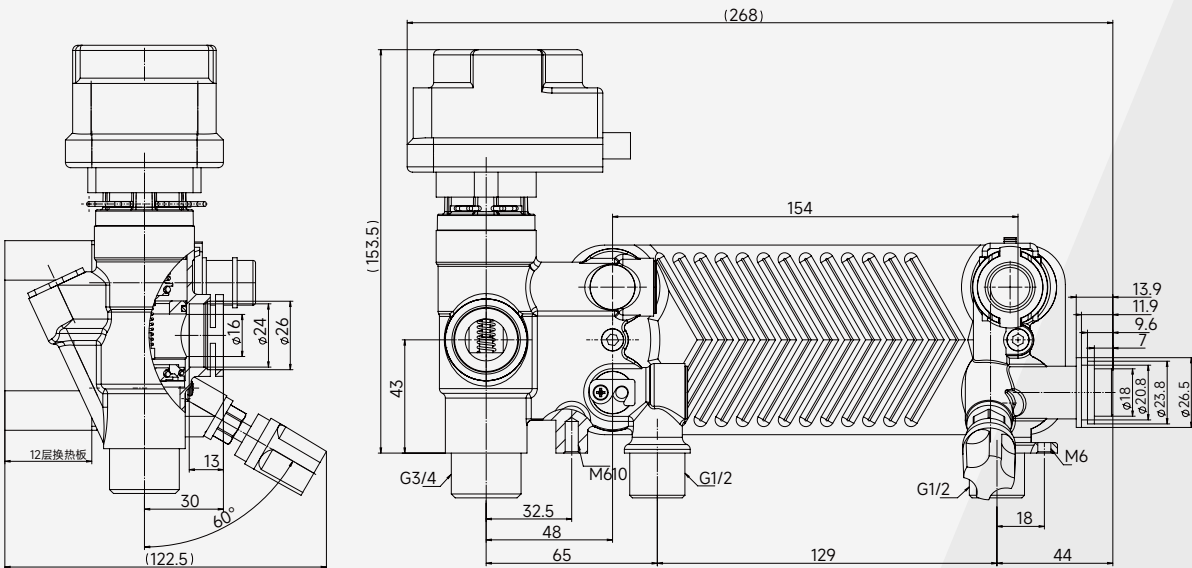

使用环境温度	-20℃ ~ 90℃ (无结冰状态)
使用湿度范围	35% ~ 90%RH (无结霜状态)
外泄露	经0.6MPa气压检测25S, 无渗漏
三通内泄露	经0.6MPa气压检测25S, 无渗漏
流量传感器工作频率	F= (8.1Q-3) ±10%
补水流量	≥6L/min
电机工作电	220V; 50Hz
旁通可选参数	5M: 0.03Mpa < 50L/h; 0.045Mpa ≥ 250L/h 6M: 0.04Mpa 50L/h 0.055Mpa ≥ 250L/h 7M: 0.05Mpa 50L/h 0.065Mpa ≥ 250L/h

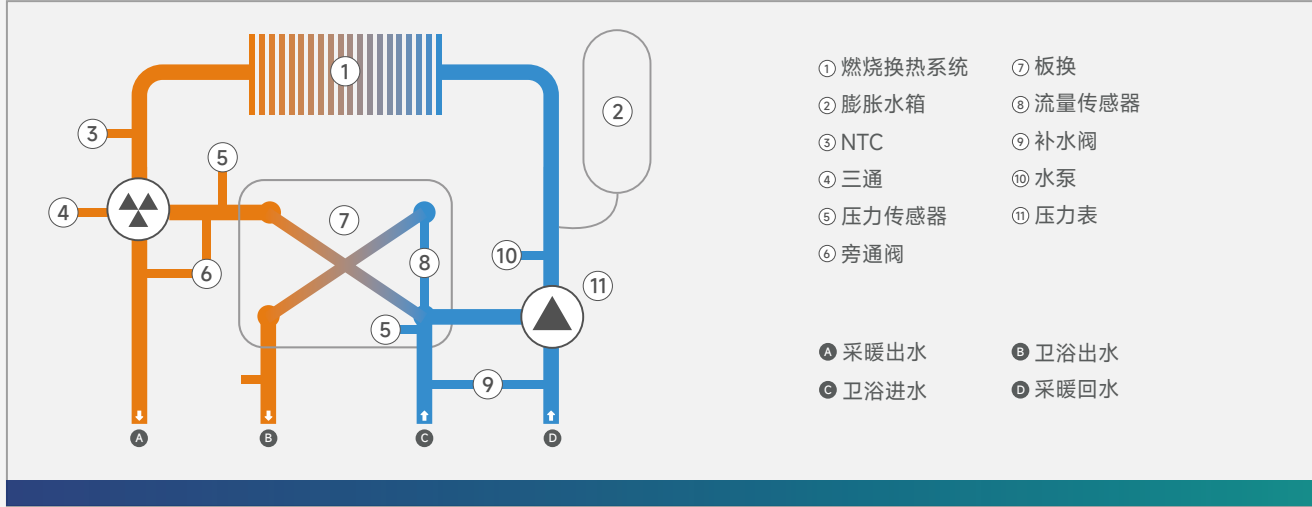

1.3 BRASS
HYDRAULIC BLOCK

铜板换水路

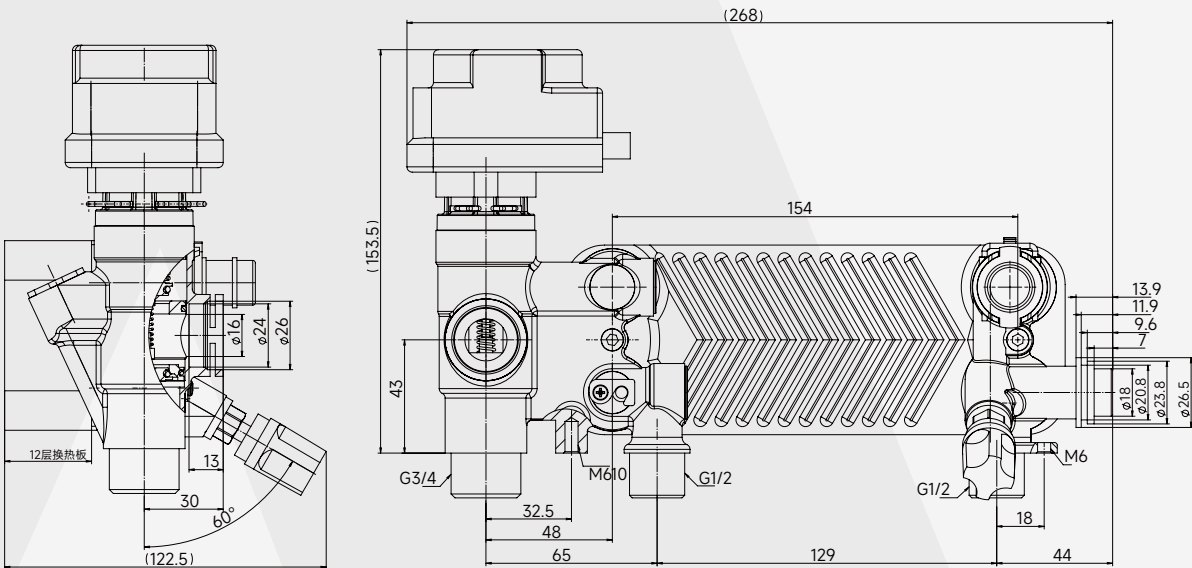

Operating Ambient Temperature	-20℃ ~ 90℃ (Ice-free)
Operating Humidity Range	35% ~ 90%RH (Frost-free)
External Leakage	No leakage was found after 25S of 0.6MPa with air pressure detection
Internal Leakage (Three-way valve)	No leakage was found after 25S of 0.6MPa with air pressure detection
Frequency of Flow Sensor	F = (8.1Q-3) ±10%
Replenishing water flow	≥6L/min
Operating Voltage	220V; 50Hz
Bypass Parameters	5M: 0.03Mpa < 50L/h; 0.045Mpa ≥ 250L/h 6M: 0.04Mpa 50L/h 0.055Mpa ≥ 250L/h 7M: 0.05Mpa 50L/h 0.065Mpa ≥ 250L/h

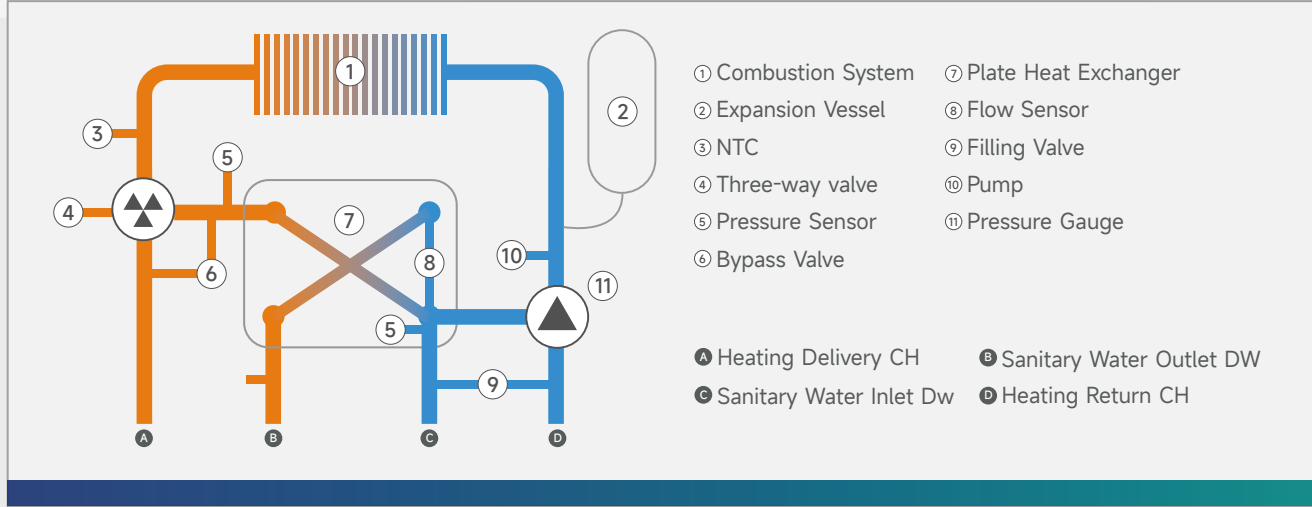

1.4 PLASTIC INTEGRATED
HYDRAULIC BLOCK

塑料集成水路

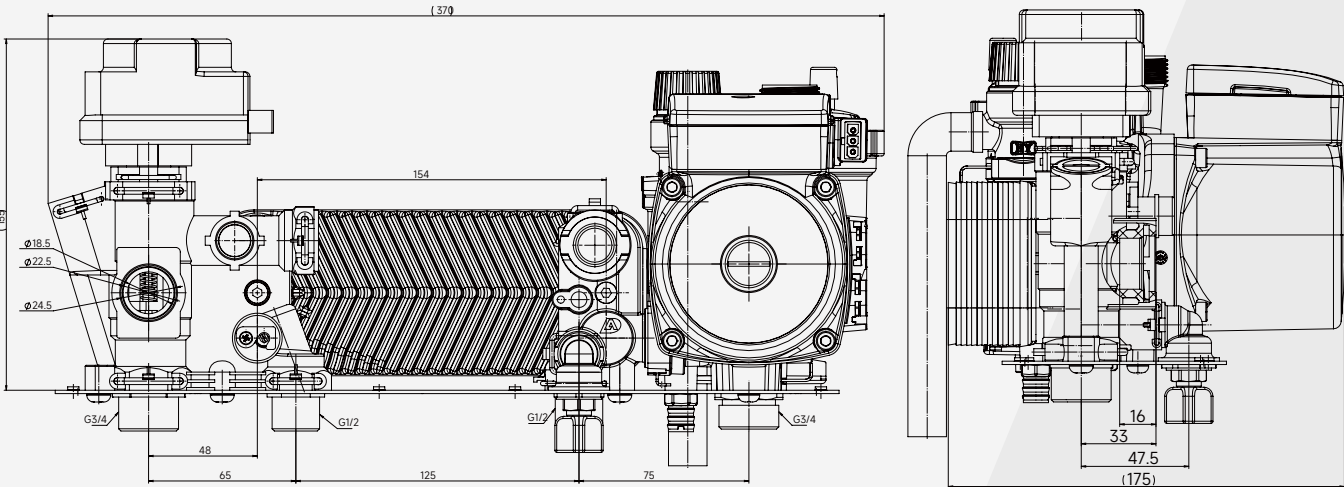

使用环境温度	-20℃ ~ 90℃ (无结冰状态)
使用湿度范围	35% ~ 90%RH (无结霜状态)
外泄露	经0.6MPa气压检测25S, 无渗漏
三通内泄露	经0.6MPa气压检测25S, 无渗漏
流量传感器工作频率	F= (8.1Q-3) ±10%
补水流量	≥6L/min
电机工作电	220V; 50Hz
旁通可选参数	5M: 0.03Mpa < 50L/h; 0.045Mpa ≥ 250L/h 6M: 0.04Mpa 50L/h 0.055Mpa ≥ 250L/h 7M: 0.05Mpa 50L/h 0.065Mpa ≥ 250L/h

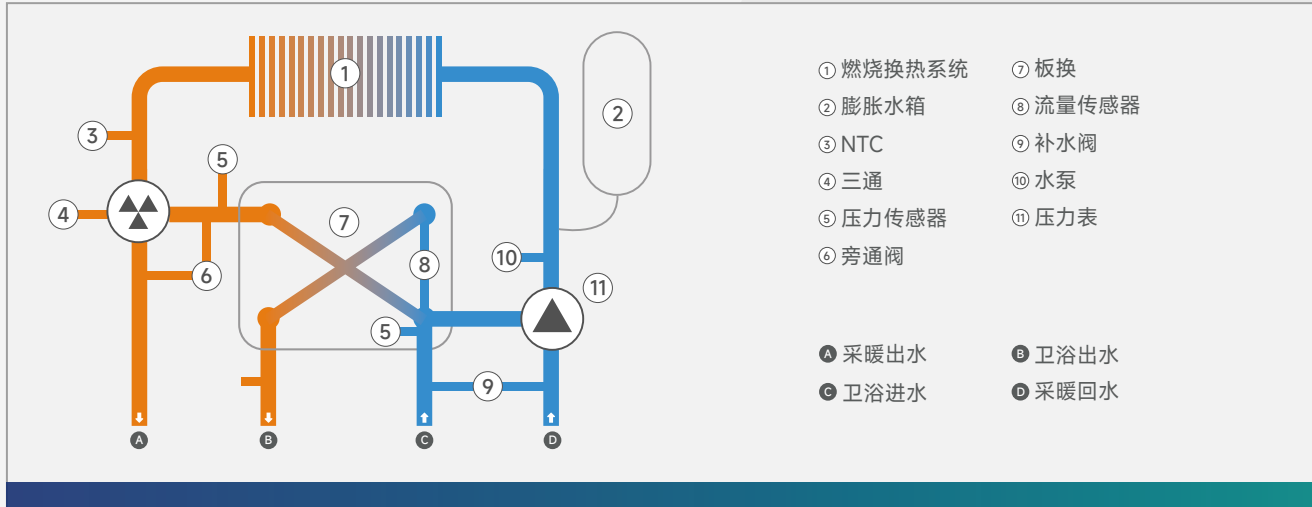

1.4 PLASTIC INTEGRATED
HYDRAULIC BLOCK

塑料集成水路

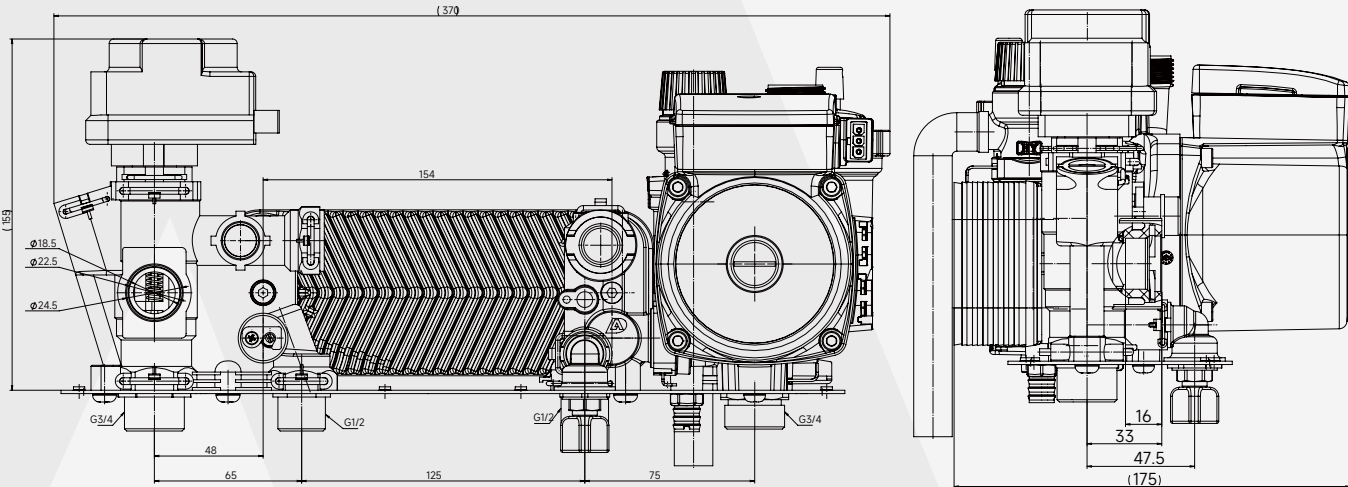

Operating Ambient Temperature	-20℃ ~ 90℃ (Ice-free)
Operating Humidity Range	35% ~ 90%RH (Frost-free)
External Leakage	No leakage was found after 25S of 0.6MPa with air pressure detection
Internal Leakage (Three-way valve)	No leakage was found after 25S of 0.6MPa with air pressure detection
Frequency of Flow Sensor	F = (8.1Q-3) ±10%
Replenishing water flow	≥6L/min
Operating Voltage	220V; 50Hz
Bypass Parameters	5M: 0.03Mpa < 50L/h; 0.045Mpa ≥ 250L/h 6M: 0.04Mpa 50L/h 0.055Mpa ≥ 250L/h 7M: 0.05Mpa 50L/h 0.065Mpa ≥ 250L/h

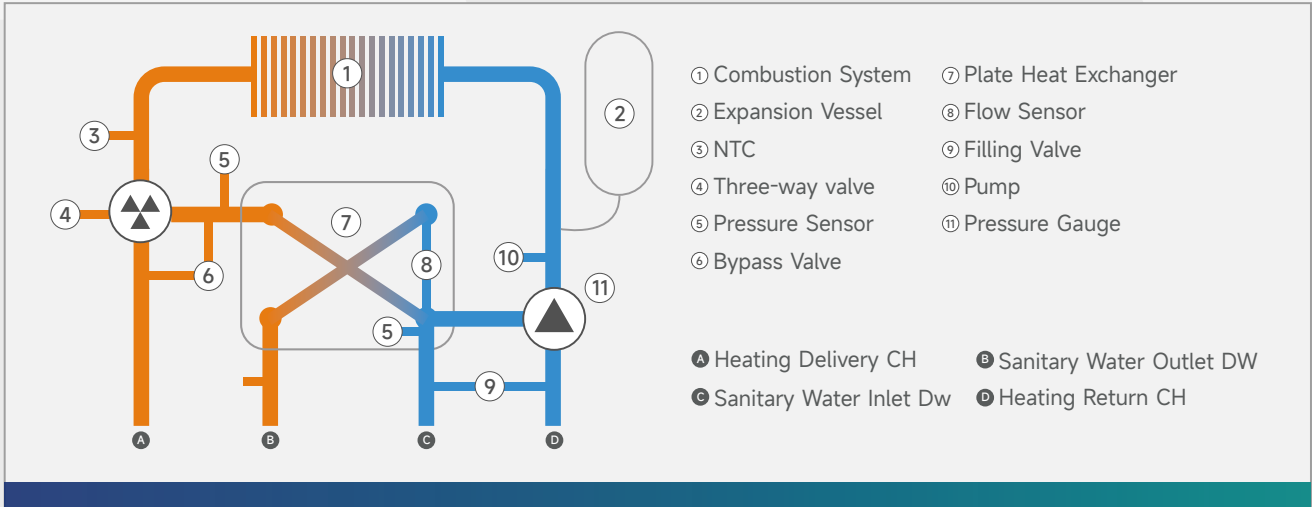

1.5 BRASS REAR - INSERTED
HYDRAULIC BLOCK

背插铜水路

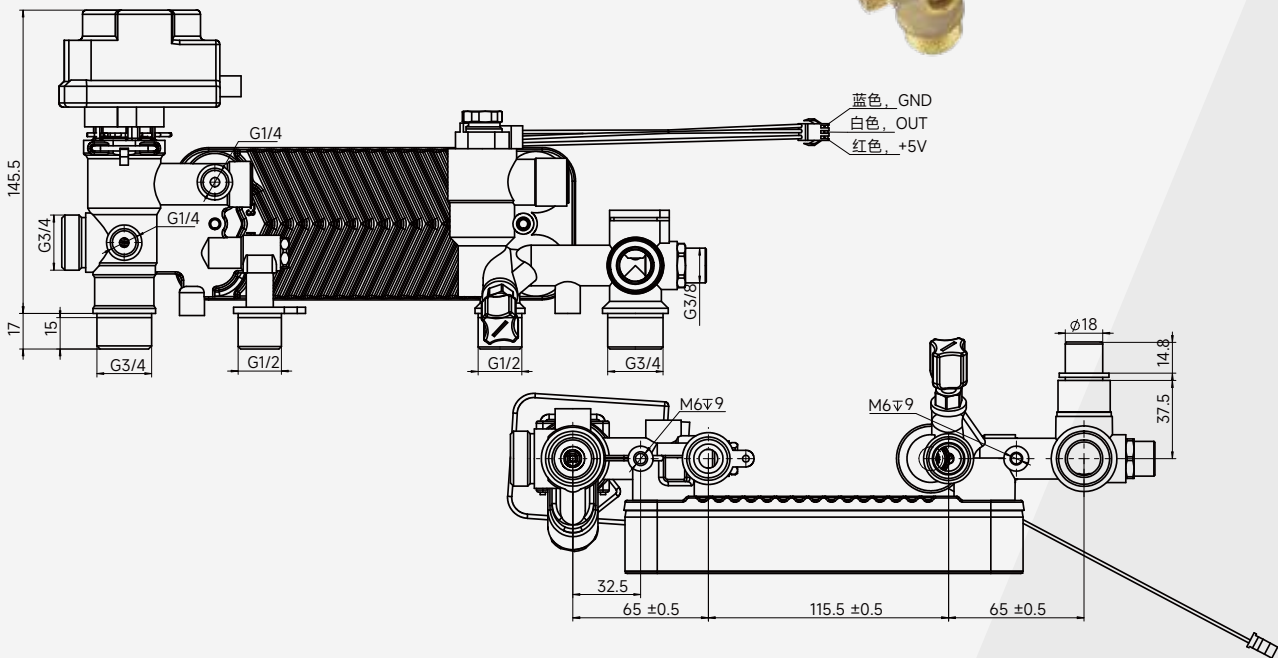

使用环境温度	-20°C ~ 90°C (无结冰状态)
使用湿度范围	35% ~ 90%RH (无结霜状态)
外泄露	经0.6MPa气压检测25S, 无渗漏
三通内泄露	经0.6MPa气压检测25S, 无渗漏
流量传感器工作频率	F= (8.1Q-3) ±10%
补水流量	≥6L/min
电机工作电	220V; 50Hz
旁通可选参数	5M: 0.03Mpa < 50L/h; 0.045Mpa ≥ 250L/h 6M: 0.04Mpa 50L/h 0.055Mpa ≥ 250L/h 7M: 0.05Mpa 50L/h 0.065Mpa ≥ 250L/h

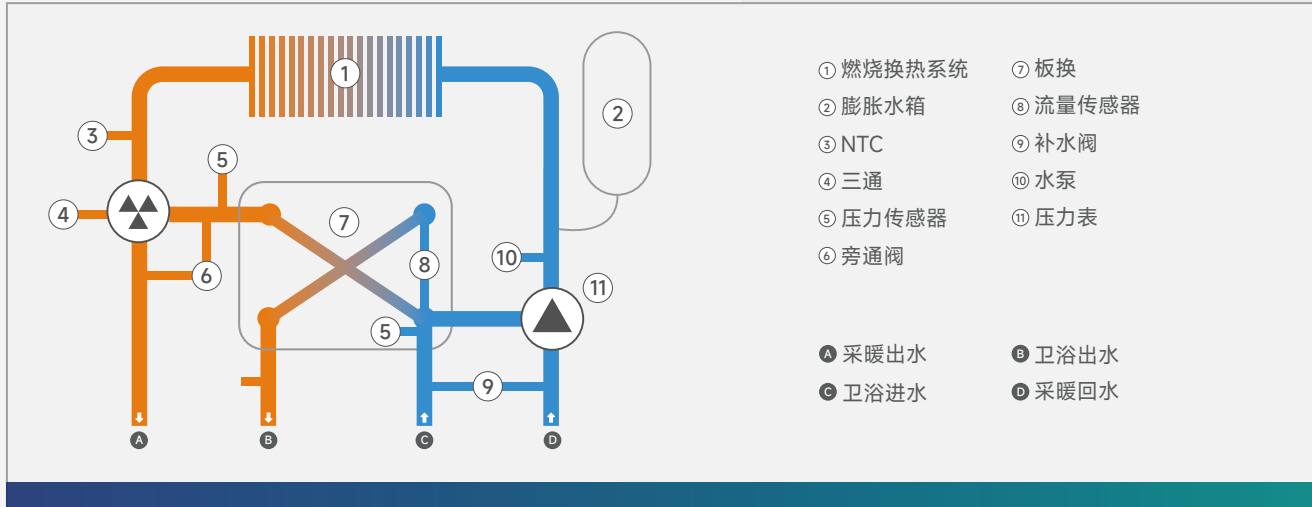

1.5 BRASS REAR - INSERTED
HYDRAULIC BLOCK

背插铜水路

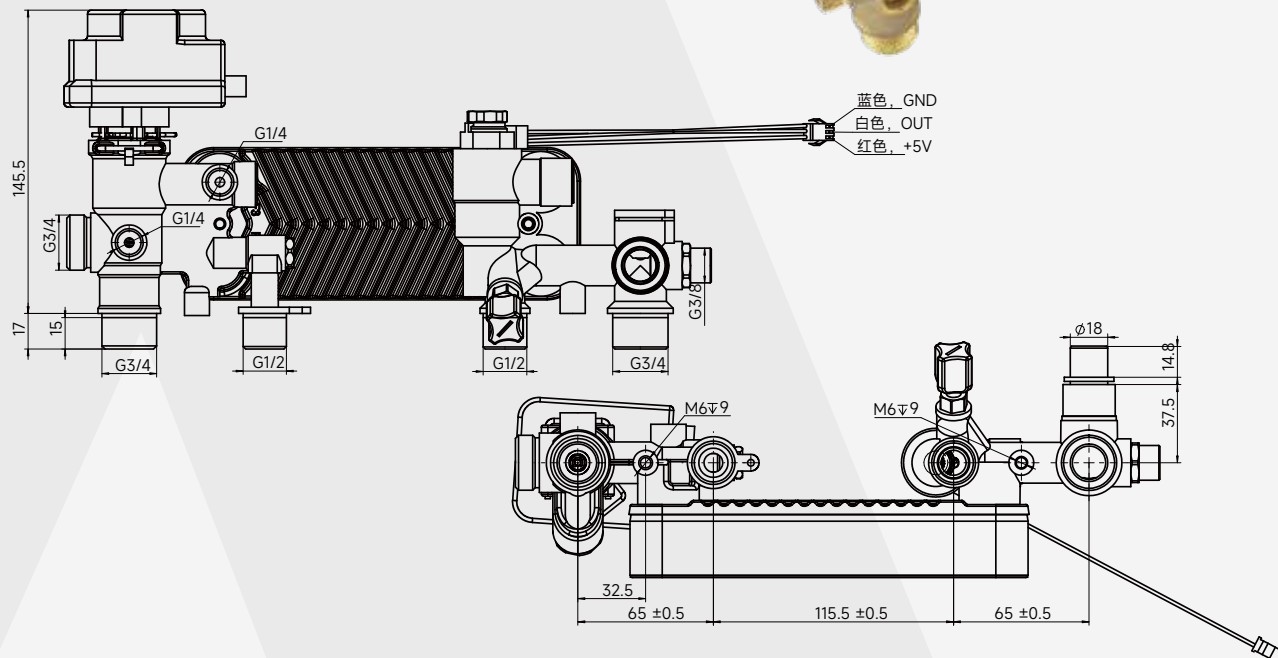

Operating Ambient Temperature	-20°C ~ 90°C (Ice-free)
Operating Humidity Range	35% ~ 90%RH (Frost-free)
External Leakage	No leakage was found after 25S of 0.6MPa with air pressure detection
Internal Leakage (Three-way valve)	No leakage was found after 25S of 0.6MPa with air pressure detection
Frequency of Flow Sensor	F = (8.1Q-3) ±10%
Replenishing water flow	≥6L/min
Operating Voltage	220V; 50Hz
Bypass Parameters	5M: 0.03Mpa < 50L/h; 0.045Mpa ≥ 250L/h 6M: 0.04Mpa 50L/h 0.055Mpa ≥ 250L/h 7M: 0.05Mpa 50L/h 0.065Mpa ≥ 250L/h

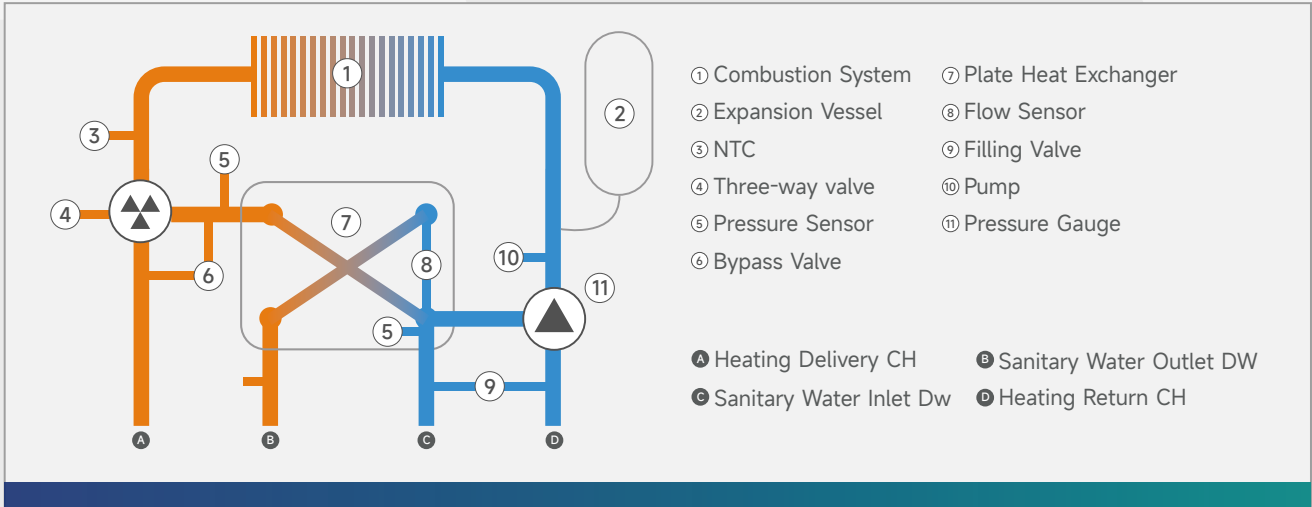

1.6 WALL- HUNG BOILERS (SAFETY VALVE)

燃气壁挂炉安全阀



PRODUCT FEATURES

”



Precise Pressure Relief, Safe And Reliable 精准泄压，安全可靠

Preset a specific opening pressure(usually 3 bar) when the system pressure When this value is reached or exceeded,the valve core automatically overcomes the spring resistance to open and relieve pressure

预设特定的开启压力（通常为3 bar），当系统压力达到或超过此值时，阀芯自动克服弹簧阻力开启泄压。



Automatic reset 自动复位

When the pressure drops to a safe value (usually about 0.5 bar lower than the opening pressure),it automatically closes under the action of the spring to prevent continuous leakage of the medium.

当压力下降至安全值（通常低于开启压力约0.5 bar）时，在弹簧作用下自动关闭，防止介质持续泄漏。



Manual Pressure Relief Rod 手动泄压杆

Equipped with a manual operating lever, manual pressure relief tests can be conducted regularly.Check if the valve is stuck or blocked to ensure it is always in a working condition

配备手动操作杆，可定期进行手动泄压测试，检查阀门是否卡死或堵塞，确保其随时处于可工作状态。

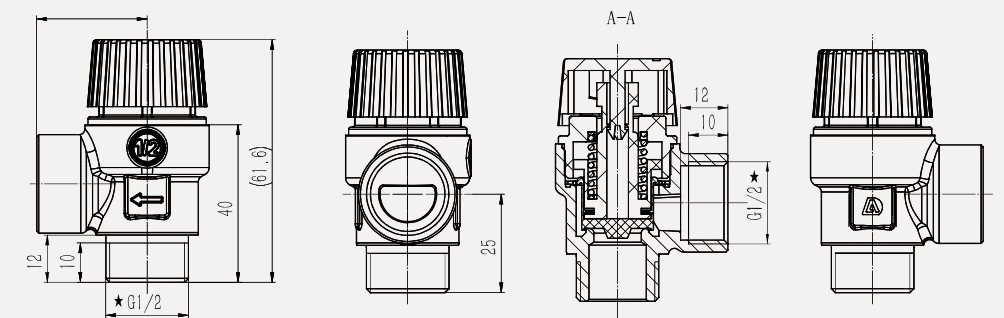
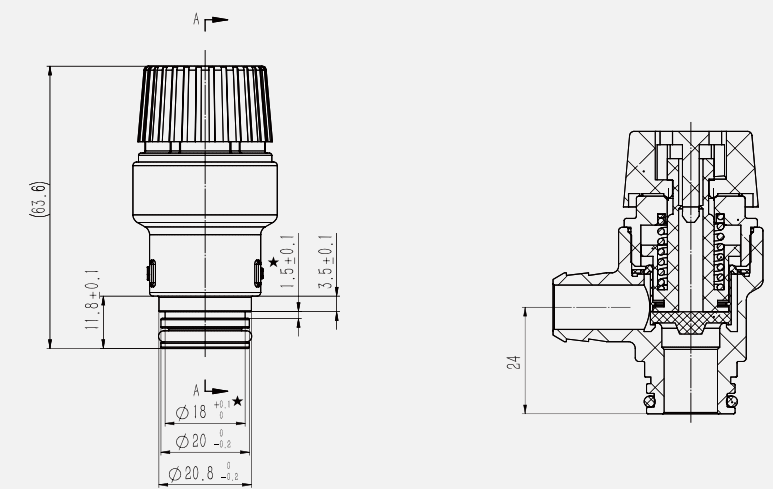
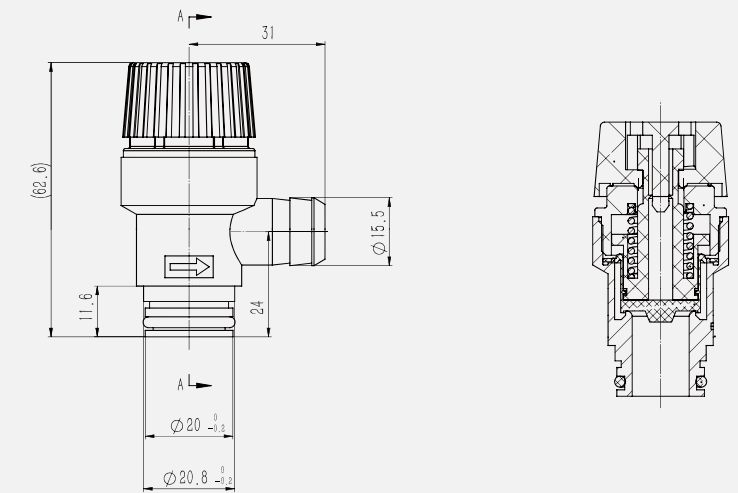

2.1 GAS WATER HEATER (INLET VALVE)

燃气热水器进水阀



PRODUCT FEATURES

”



Suitable for Inlet/Outlet Valves of Gas Water Heaters
适用于燃气热水器进出水阀



Material: Made of premium cutting brass
(e.g., CuZn39Pb2, C37700)
材质：选用优质切削黄铜
(如CuZn39Pb2 、C37700等)



Surface Treatment: Including shot blasting
electroplating, and color preservation
表面处理：如抛丸，电镀、保色等



Processing Method:
Forging + Machining
加工方式：锻造、机加工



Thread Connection Types:
Imperial threads (G, R) Metric threads (M), etc
螺纹连接形式：英制 (G、R)、公制螺纹 (M) 等

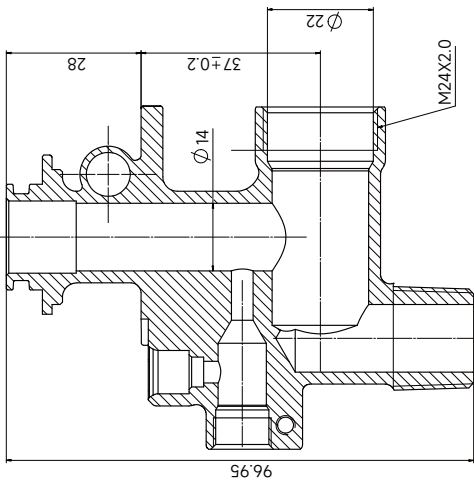

2.2 GAS WATER HEATER (OUTLET VALVE)

燃气热水器出水阀



PRODUCT FEATURES

”



Suitable for core components
of gas water heaters
适用于燃气热水器核心配件



Material: High-quality machined brass
(e.g., CuZn39Pb2, C37700) is selected
材质：选用优质切削黄铜
(如CuZn39Pb2 、C37700等)



Surface treatment: such as polishing,
sandblasting treatment, etc
表面处理：如抛丸，磨料震、保色等



Processing method: Machining
(precision CNC lathe, machining center)
加工方式：机加工 (精密数控车床、加工中心)



Threaded connection forms:
imperial (G, R), metric (M) threads, etc
螺纹连接形式：英制 (G、R)、公制螺纹 (M) 等

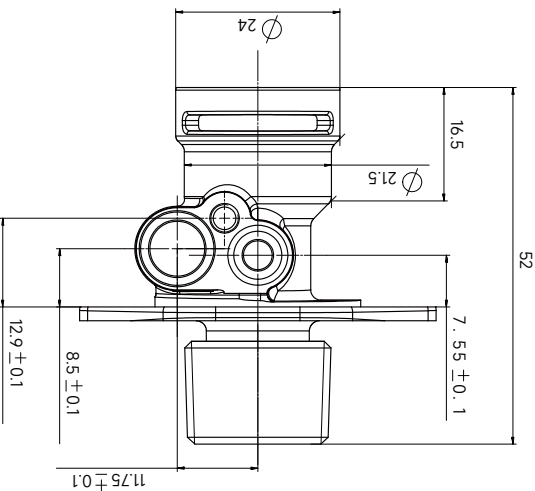

3. TANK WATER HEATER (T&P RELIEF VALVE)

容积式热水器TP阀

PRODUCT INTRODUCTION

The T&P Relief Valve incorporates an inert thermal element coating that provides effective isolation from mineral deposits (liming) and galvanic corrosion. The features include a forge brass body, brass and stainless steel internal parts, silicone seat disc and stainless steel spring. It comes standard with a test lever. The valve can automatically open a relief vent when either the pressure or temperature reaches a predetermined value and reseats again when the pressure or temperature returns to normal. The valve is available in male inlets and female outlets with several options in shank and element lengths. Every valve is tested for performance prior to shipping to specify and install with confidence!

产品介绍

T/P 安全阀采用惰性温感探头涂层工艺,能有效隔离矿物质沉积(结垢)及电偶腐蚀。产品主要特征包括:锻造黄铜阀体、黄铜及不锈钢内部组件、硅胶密封阀瓣以及不锈钢弹簧,并标配手动测试手柄。当系统压力或温度达到预设阈值时,阀门会自动开启排泄口进行泄压;一旦压力或温度恢复正常,阀门将自动回座关闭。产品提供外螺纹(公)进水口与内螺纹(母)出水口配置,并有多款阀柄长度及探头长度可供选择。每一只阀门在出厂前均通过严格的性能测试,确保选型与安装安全可靠!

Item No.	Thread	Set Pressure	Set Temperature	Discharge Capacity	A	B	C	D
Tp-Hy01	Npt3/4	75、100、125、150psi	93.5~99°C	105000btw/Hr	103	82.4	46	26.4
Tp-Hy03	Npt 1	75、100、125、150psi	93.5~99°C	500000btu/Hr	101.5	149	71.5	35

型 号	螺纹规格	整定压力	整定温度	排 量	A	B	C	D
TP-HY01	NPT3/4	75、100、125、150PSI	93.5~99°C	105000BTW/HR	103	82.4	46	26.4
TP-HY03	NPT 1	75、100、125、150PSI	93.5~99°C	500000BTU/HR	101.5	149	71.5	35

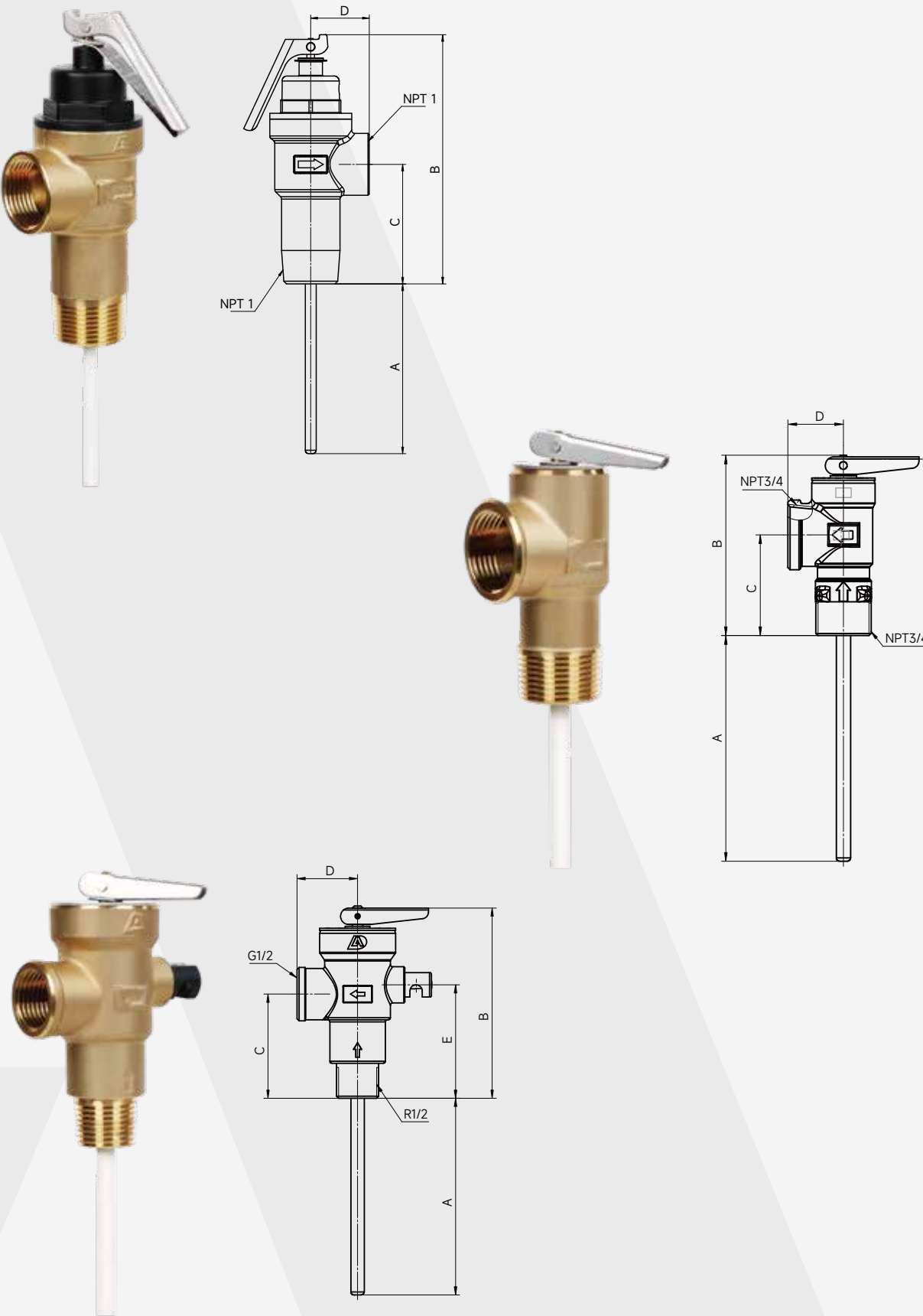

4. SANITARY ACCESSORIES

智能卫浴配件



Suitable for bathroom plumbing connections and fittings
适用于卫浴管路连接件



Material: Made of
premium cutting brass
(e.g., CuZn39Pb2, C37700)
材质: 选用优质切削黄铜
(如CuZn39Pb2、C37700等)



Surface Treatment: Including shot blasting, electroplating, and color preservation
表面处理：如抛丸，电镀、保色等



Processing Method:
Forging + Machining
加工方式：锻造+机加工



Thread Connection Types:
Imperial threads (G, R),
Metric threads (M), etc
螺纹连接形式：英制（G、R）公制螺纹（M）等

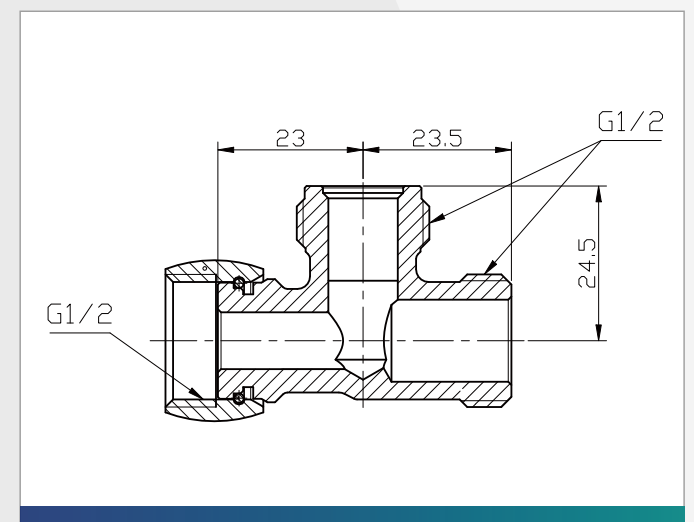
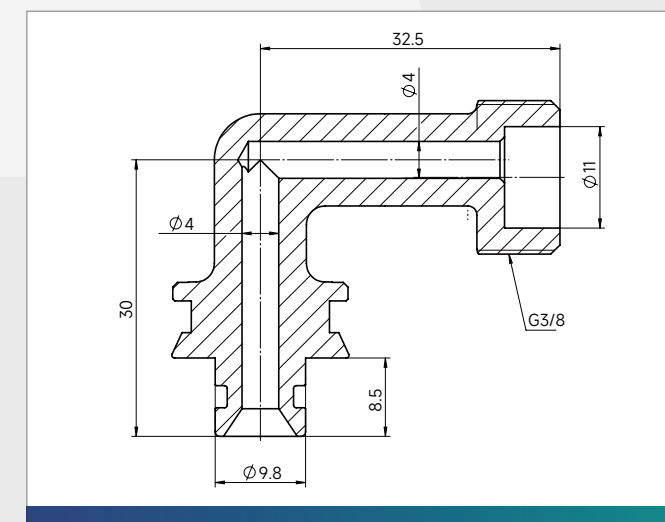
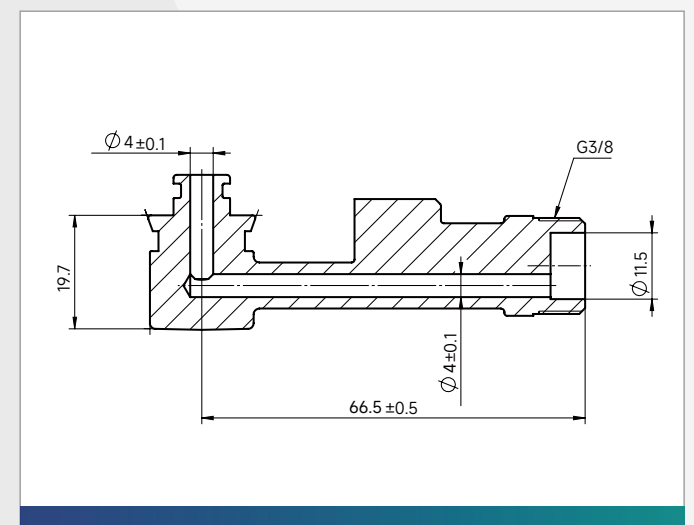
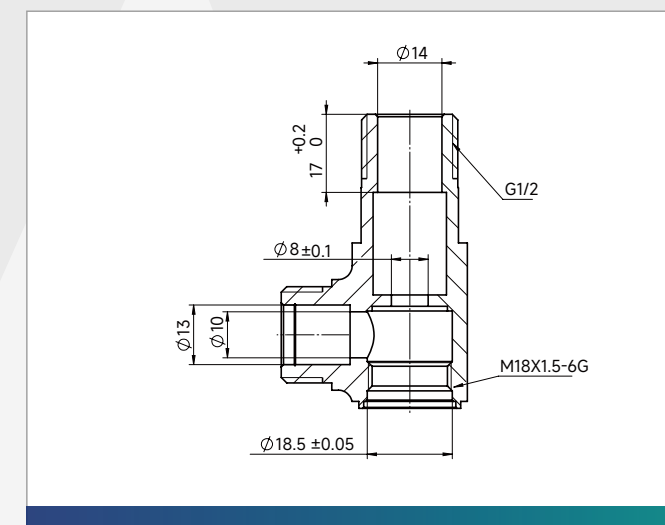
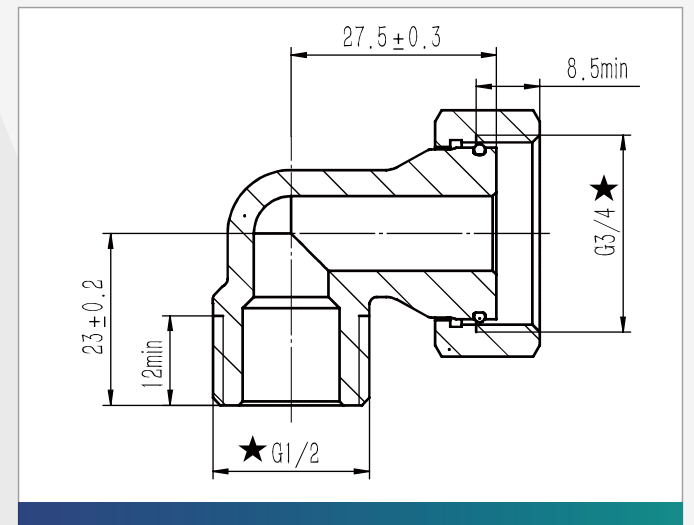
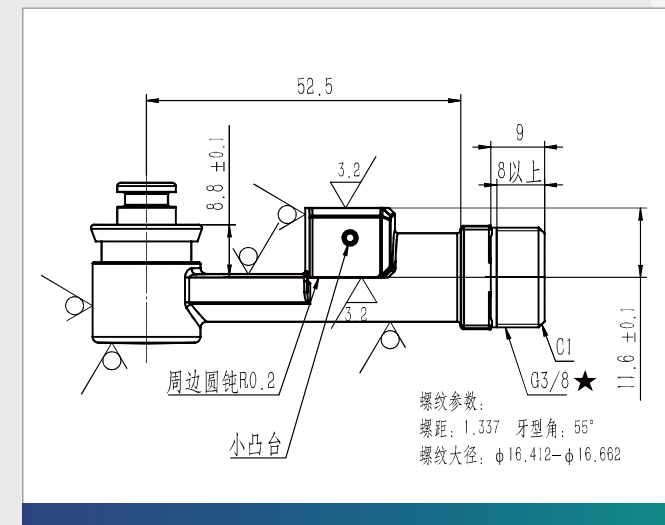

5. WELDING & CUTTING ACCESSORIES

焊割减压器配件



PRODUCT INTRODUCTION

With extensive expertise deeply rooted in the welding and cutting industry, we specialize in supplying a comprehensive range of components for torches and gas regulators. Our product portfolio ranges from torch bodies, heads, tailpieces, and high - pressure levers to hose fittings and regulator bonnets (upper and lower housings), offering a complete solution for your assembly requirements.

产品介绍

深耕焊接焊割行业多年,专业供应多品类焊割枪配套零部件与减压器相关组件。产品涵盖焊割炬本体、割炬枪头、尾部、高压手柄、气管接头及减压器上盖、下盖等核心零件,全方位满足装配需求。

5.1 GAS REGULATOR BODY

减压器主体系列



PRODUCT FEATURES

”



Core accessories for gas pressure regulators suitable for welding and cutting torches
适用于焊割炬气体减压器核心配件



Material: High-quality machined brass (e.g., CuZn39Pb2, C37700) is selected
材质: 选用优质切削黄铜 (如CuZn39Pb2 、C37700等)



Surface treatment: such as polishing, electroplating, etc
表面处理: 如抛光、电镀等



Processing method: Machining (precision CNC lathe, machining center)
加工方式: 机加工 (精密数控车床、加工中心)



Threaded connection form: American standard (UNC, UNEF) Imperial (G, R), metric (M) threads, etc
螺纹连接形式: 美制 (UNC、UNEF)、英制 (G、R)、公制螺纹 (M) 等

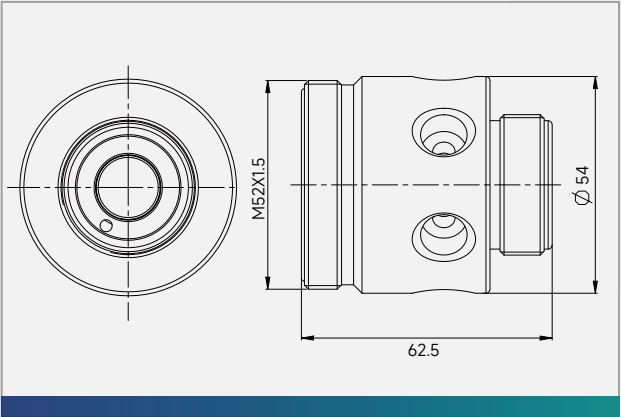

5.2 GAS REGULATOR BODY

减压器主体系列



PRODUCT FEATURES

”



Core accessories for gas pressure regulators suitable for welding and cutting torches
适用于焊割炬气体减压器核心配件



Material: High-quality machined brass (e.g., CuZn39Pb2, C37700) is selected
材质: 选用优质切削黄铜 (如CuZn39Pb2、C37700等)



Surface treatment: such as polishing, electroplating, etc
表面处理: 如抛光、电镀等



Processing method: Machining (precision CNC lathe, machining center)
加工方式: 机加工 (精密数控车床、加工中心)



Threaded connection form: American standard (UNC, UNEF) Imperial (G, R), metric (M) threads, etc
螺纹连接形式: 美制 (UNC、UNEF)、英制 (G、R)、公制螺纹 (M) 等

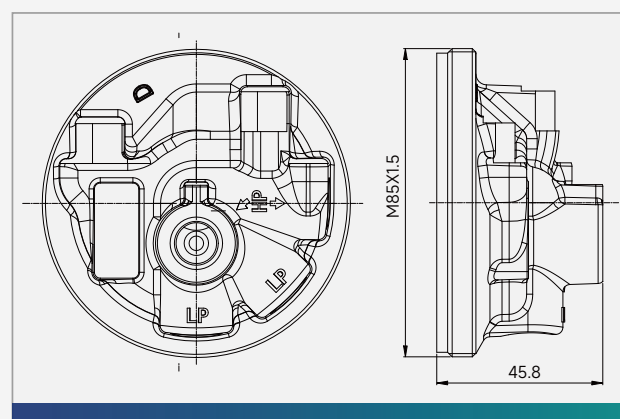

5.3 GAS REGULATOR BONNET

减压器主体盖系列



PRODUCT FEATURES

”



Core accessories for gas pressure regulators suitable for welding and cutting torches
适用于焊割炬气体减压器核心配件



Material: High-quality machined brass (e.g., CuZn39Pb2, C37700) is selected
材质: 选用优质锻造黄铜 (如CuZn39Pb2、C37700等)



Surface treatment: such as polishing, electroplating, etc
表面处理: 如震光、喷砂处理等



Processing method: Machining (precision CNC lathe, machining center)
加工方式: 锻造 (摩擦压力机) + 机加工 (精密数控车床、加工中心)



Threaded connection form: American standard (UNC, UNEF) Imperial (G, R), metric (M) threads, etc
螺纹连接形式: 美制 (UNC、UNEF)、英制 (G、R)、公制螺纹 (M) 等

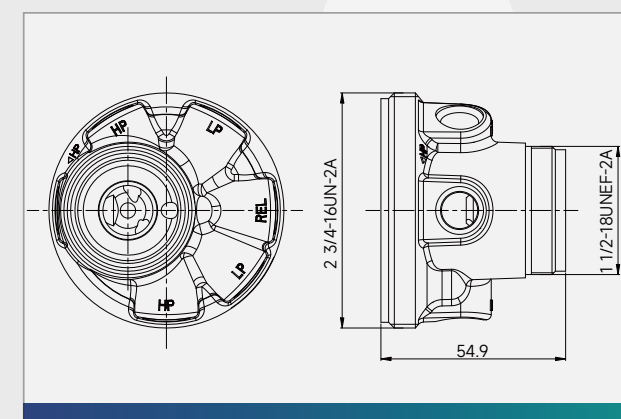

6. HIGH-PRESSURE WASHER ACCESSORIES

高压清洗机配件



PRODUCT INTRODUCTION

With years of experience in manufacturing core components for high-pressure washers, and drawing upon four core competencies — high quality material selection, high-precision machining, full-process quality control, and efficient delivery — we are consistently dedicated to customizing brass and stainless steel pump manifolds and accessories to meet the diverse requirements of our clients.

We have established a comprehensive, end-to-end quality control system involving strict incoming material inspection, real-time process monitoring, and comprehensive final inspection. By strictly adhering to standardized procedures at every stage, we guarantee the stability and reliability of every product, thereby delivering solutions that combine high precision with exceptional durability.

产品介绍

深耕高压清洗机核心部件生产多年,始终以客户定制化需求为导向,凭借优质选材、高精度加工、全流程品控、高效交付四大核心竞争力,专业供应黄铜、不锈钢系列泵头及配套零部件。

我们建立原料入厂严格质检、生产工序实时监测、成品出厂全面复检的全链条品控体系,各环节均严格遵循标准化流程,确保每台泵头性能稳定、品质可靠,为客户提供兼具高精度与高耐用性的高品质核心部件解决方案。

6.1 BRASS PUMP HEAD

黄铜泵头



PRODUCT FEATURES

”



Applicable to high-pressure washers
适用于高压清洗机



Material: High-quality forged brass
(e.g., CuZn39Pb2, C37700) is selected
材质: 选用优质锻造黄铜
(如CuZn39Pb2、C37700等)



Surface treatment: such as polishing,
sandblasting treatment, etc
表面处理: 如抛光、喷砂处理等



Processing method: Forging (friction press) +
machining (precision CNC lathe, machining center)
加工方式: 锻造 (摩擦压力机)
+机加工 (精密数控车床、加工中心)

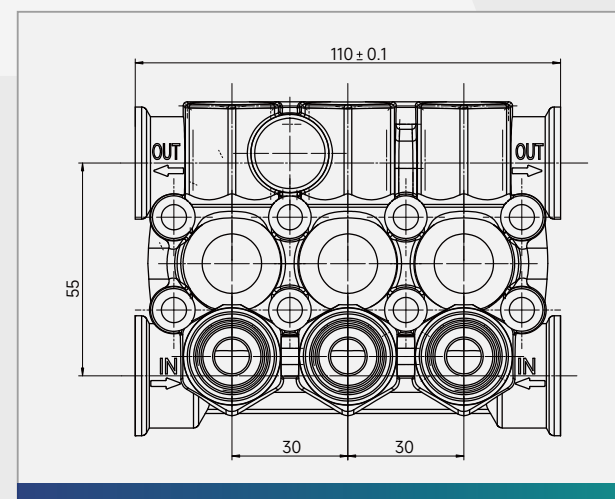

6.2 BRASS PUMP HEAD

黄铜泵头



PRODUCT FEATURES

”



Applicable to high-pressure washers
适用于高压清洗机



Material: High-quality forged brass
(e.g., CuZn39Pb2, C37700) is selected
材质：选用优质锻造黄铜
(如CuZn39Pb2、C37700等)



Surface treatment: such as polishing,
sandblasting treatment, etc
表面处理：如震光、喷砂处理等



Processing method: Forging (friction press) +
machining (precision CNC lathe, machining center)
加工方式：锻造（摩擦压力机）
+机加工（精密数控车床、加工中心）

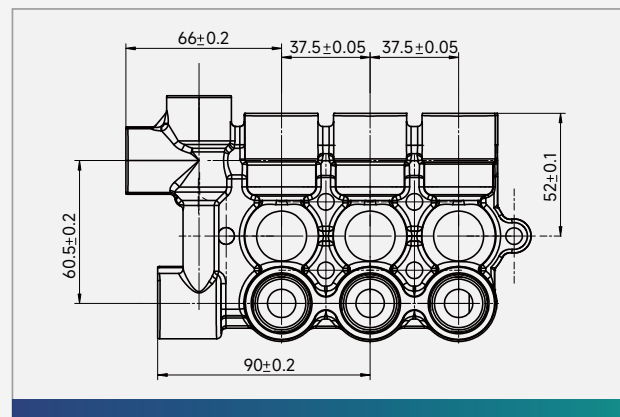

6.3 STAINLESS STEEL PUMP HEAD

不锈钢泵头



PRODUCT FEATURES

”



Applicable to high-pressure washers
适用于高压清洗机



Material: Corrosion-resistant stainless
steel (such as SUS304, SUS316L, etc.
材质：选用耐腐蚀的不锈钢
(如SUS304, SUS316L等)



Surface treatment: such as
sandblasting, passivation treatment, etc
表面处理：如喷砂、钝化处理等



Processing method: Cold heading
+machining (precision CNC lathe,
machining center) + surface treatment
加工方式：冷镦+机加工（精密数控车床、
加工中心）+表面处理

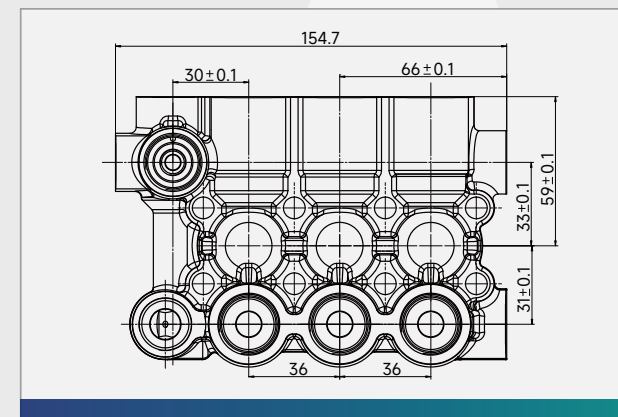

7. SENSOR ACCESSORIES

传感器配件

PRODUCT INTRODUCTION

Specializing in manufacturing the core metal components for sensors, this product line encompasses metal housings for both temperature and pressure sensors widely used in the Refrigeration and HVAC sectors.

We strictly follow the automotive-grade standards by using Stainless Steel (SUS314, SUS316) and various brass alloys to ensure both high strength and corrosion resistance. Through precision CNC machining, automated welding, Non-Destructive Testing (NDT), and specialized surface treatments, we guarantee exceptional dimensional consistency, structural sealing integrity, and long-term stability, thereby contributing to superior sensor performance and extended service life.

产品介绍

专注于传感器的核心金属部件制造,产品涵盖各类温度、压力传感器的金属壳体,广泛应用于制冷、HVAC 等领域。在材料选择与制造工艺上,我们始终坚持汽车行业的高标准。主要部件广泛选用 SUS314、SUS316 等不锈钢材料和各类牌号的黄铜材料,兼顾强度与耐腐蚀性。通过精密数控 CNC 加工、自动化焊接、无损检测及专业化表面处理等工艺,我们确保产品具备优异的尺寸一致性、结构密封性与长期使用稳定性,助力客户提升传感器整体性能与使用寿命。



7.1 HVAC PRESSURE TRANSDUCER

商用空调压力传感器



PRODUCT FEATURES

-  The core carrier of the sensor
传感器的核心载体
-  Material: Corrosion-resistant stainless steel (such as SUS314 SUS316L, etc.) + red copper tube (TP2) is selected
材质: 选用耐腐蚀的不锈钢 (SUS314 SUS316L等) + 紫铜管 (TP2)
-  Advantages: Sturdy structure and strong mechanical protection; Fast response speed; Brazing welding ensures reliable sealing
优点: 结构坚固, 机械保护性强; 响应速度快; 钎焊焊接, 密封可靠
-  Welding leakage defect rate: 0ppm
焊接泄漏不良率: 0ppm

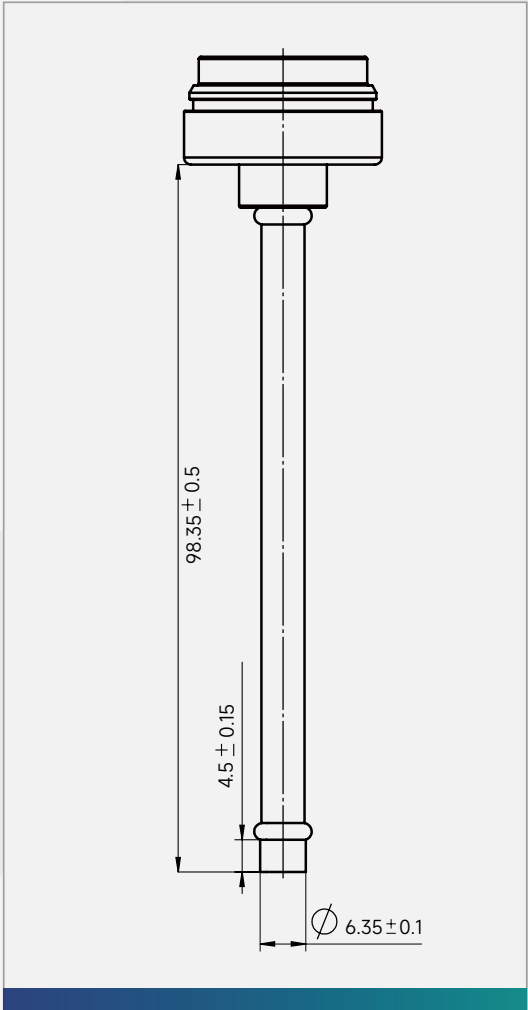

8. PIPE FITTINGS

管路件



PRODUCT FEATURES

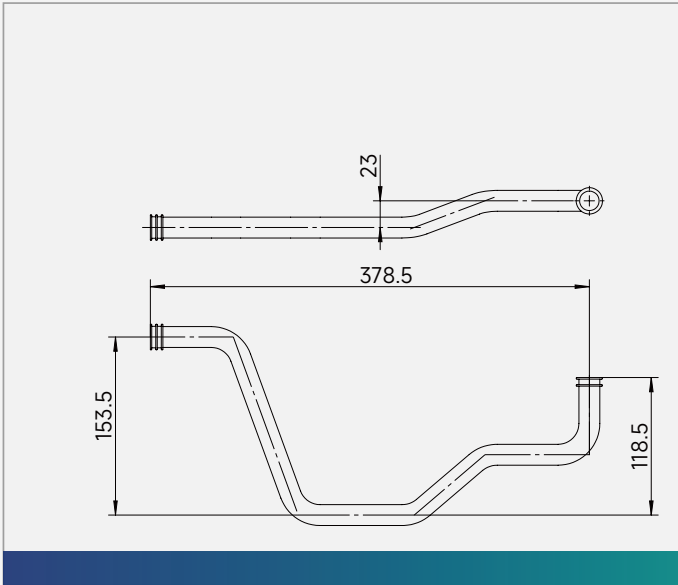

Used for pipeline connections in water heaters and wall-hung boilers
用于热水器、壁挂炉管路连接



Material: TP2 copper tube or stainless steel (SUS304) is selected
材质：选用TP2紫铜管或不锈钢（SUS304）



Connection Types: Threaded connection quick-connect (push-fit) connection welded connection, etc
连接形式：螺纹连接、快插连接、焊接连接等



PRODUCT FEATURES



Used for pipeline connections in water heaters and wall-hung boilers
用于热水器、壁挂炉管路连接



Material: TP2 copper tube or stainless steel (SUS304) is selected
材质：选用TP2紫铜管或不锈钢（SUS304）



Connection Types: Threaded connection quick-connect (push-fit) connection welded connection, etc
连接形式：螺纹连接、快插连接、焊接连接等

